

H1558 (Revised June 2019)

# Starting a Community Orchard in North Dakota





Dear Friends,

We are excited to bring you this publication. Its aim is to help you establish a fruit orchard in your community. Such a project combines horticulture, nutrition, community vitality, maybe even youth. All of these are areas in which NDSU Extension has educational focuses. Local community orchard projects can improve the health of those who enjoy its bounty.

This Starting a Community Orchard in North Dakota publication also is online at [www.ag.ndsu.edu/publications/lawns-gardens-trees/starting-a-community-orchard-in-north-dakota](http://www.ag.ndsu.edu/publications/lawns-gardens-trees/starting-a-community-orchard-in-north-dakota) so you can have it in a printable PDF or mobile-friendly version if you don't have the book on hand.

True to our mission, NDSU Extension is proud to empower North Dakotans to improve their lives and communities through science-based education by providing this publication. We also offer many other educational resources focused on other horticultural topics such as gardening, lawns and trees.

If you're especially passionate about horticulture and sharing your knowledge, consider becoming an NDSU Extension Master Gardener. After training, as a Master Gardener volunteer, you will have the opportunity to get involved in a wide variety of educational programs related to horticulture and gardening in your local community by sharing your knowledge and passion for horticulture!

Learn about NDSU Extension horticulture topics, programs, publications and more at [www.ag.ndsu.edu/extension/lawns\\_gardens\\_trees](http://www.ag.ndsu.edu/extension/lawns_gardens_trees).

We hope this publication is a valuable educational resource as you work with community orchards in North Dakota.

Sincerely,



Greg Lardy  
Interim Director, NDSU Extension



COMMISSIONER  
DOUG GOEHRING



ndda@nd.gov  
www.agdepartment.com

**NORTH DAKOTA**  
**DEPARTMENT OF AGRICULTURE**  
STATE CAPITOL  
600 E BOULEVARD AVE DEPT 602  
BISMARCK ND 58505-0020

Dear Friend:

Starting a community orchard takes effort but is a worthwhile and rewarding project! A community orchard can help foster community spirit, provide service hours to individuals in a community and can be used as an outdoor living classroom for education in local schools.

Community members and students can learn about proper planting, watering, pruning, tree care, pollination, harvesting, fruit preservation and more. Orchards also provide fruits for the community, schools and those in need.



This manual was developed to assist you in all aspects of orchard development. It is a great resource that you can use in planning, budgeting and maintaining an orchard.

To ensure you are planting trees and shrubs that will thrive in our climate, be sure to avoid non-hardy trees and shrubs. A detailed listing is available on the North Dakota Department of Agriculture website at <https://www.nd.gov/ndda/program/nursery-program>. A plant hardiness zone map is available at <http://planthardiness.ars.usda.gov/>.

Since 2012, the North Dakota Department of Agriculture has funded 69 orchard projects. We can be a resource to you, providing ideas and best practices to get an orchard started. We can also connect you to others who have embarked on this process. Please reach out to our office if you have any questions.

Sincerely,

A handwritten signature in blue ink that reads "Doug Goehring".

Doug Goehring  
North Dakota Agriculture Commissioner

**NDSU** | EXTENSION

**NDSU** NORTH DAKOTA AGRICULTURAL  
EXPERIMENT STATION



Written by

Tom Kalb, North Dakota State University (NDSU) Extension  
Kathy Wiederholt, NDSU Carrington Research Extension Center  
Charles Elhard, North Dakota Department of Agriculture  
Jamie Good, North Dakota Department of Agriculture

This resource is made possible through collaboration of NDSU Extension, NDSU North Dakota Agricultural Experiment Station and North Dakota Department of Agriculture.

The authors are grateful to the late Chuck Fleming, formerly with the North Dakota Department of Agriculture, as well as Greg Lardy, Harlene Hatterman-Valenti, Stevan Sagaser, Ron Smith and Todd Weinmann of NDSU Extension for their assistance in making this publication possible.

Publication H1558  
Revised June 2019



# Starting a Community Orchard in North Dakota

## Contents

---

<b>Chapter 1. Introduction</b>	2		
<b>Chapter 2. Starting Your Orchard</b>			
Selecting Your Site	3		
Preparing the Land	4		
Buying Plants	4		
Planting	5		
Pruning	6		
Fertilizing	6		
Watering	6		
Mulching	6		
Staking	6		
Trellising	7		
Wrapping and Painting	7		
Managing Wildlife	7		
Spraying	8		
Pruning and Training Young Trees	9		
Rejuvenating Old Apple Trees	11		
<b>Chapter 3. Fruits for North Dakota</b>			
<i>Tree Fruits</i>			
Apple	12		
Apricot	14		
Cherry	14		
Cherry Plum	15		
Crabapple	15		
Peach	16		
Pear	16		
Plum	17		
		<i>Small Fruits</i>	
		Aronia	18
		Blueberry	18
		Currants	19
		Dwarf Sour Cherry	19
		Elderberry	20
		Gooseberry	20
		Grape	21
		Hazelnut	21
		Honeyberry	22
		Juneberry	22
		Raspberry	23
		Rhubarb	24
		Seaberry	24
		Strawberry	25
		<b>Chapter 4. Starting Your Organization</b>	
		Structure	26
		Liability	27
		<b>Chapter 5. Ten Steps to a Community Orchard</b>	28
		<b>Chapter 6. Featured North Dakota Orchards</b>	
		Aneta Community Orchard	30
		Prairie Dawn Community Orchard	31
		<b>Appendices</b>	
		1. Sources of Plants and Supplies	32
		2. Sample Budget	33
		3. Funding Opportunities	34
		4. Sample Contract for Land Use	35
		5. Sample Bylaws	36
		6. Sources for Technical Advice	38
		7. Hunger Free North Dakota Garden Project	39
		<b>Sources and Photo Credits</b>	40

# Introduction

Community orchards are growing all across America today. These orchards are being established by local organizations looking to beautify their land and grow healthy food for their people.

A community orchard is owned, leased or held in agreement by a community group or local authority. Community orchards can provide a place for gardening, relaxation, pleasure and healing.

The orchards can be found anywhere, including parks, schools, churches, hospitals, jails and farms. Activities in these orchards are as diverse as the groups who manage them:

- Some orchards focus on fruit production, while others serve as outdoor classrooms for education.
- Some orchards are developed for youth programs, while others are developed into a living museum honoring a community's history.
- Some orchards serve as the center of a community festival, while others serve as an alcove of peace and tranquility.
- Some orchards are fenced to keep wildlife out, while others try to attract wildlife.

The success of a community orchard will depend on the commitment and resources of the local people who manage it. Community orchards usually are open and accessible to the community

at all times. As well as enjoying the surroundings, local people can share the harvest or profit from its sales, taking responsibility for work in the orchard (Common Ground, 2011).

Community orchards can be valuable assets to communities in North Dakota. Our people need to eat more fruits. Only 30 percent of North Dakotans consume the recommended amount of fruits needed for good health (two servings per day). This deficiency stunts the mental and physical growth of our children. This deficiency makes us more susceptible to infectious diseases (such as colds and flu) and chronic diseases (such as diabetes and cancer). This deficiency contributes to obesity and related health concerns (Centers for Disease Control and Prevention, 2012).

North Dakota is one of the leading agricultural states in America, yet it ranks 48th in fruit production (U.S. Department of Agriculture, 2019). An increase in locally grown fruit will increase our access to fruits and encourage greater fruit consumption in our daily diets.

Community orchards can be used to grow fruits for profit. A 2008 survey of North Dakota's farmers markets showed a great need for more farmers and fruits at the markets.

Many of our communities have open parcels of land with access to water. These plots could be future sites of orchards where communities can host local events, plus grow food for their families.

This publication is a guide to help North Dakotans start community orchards. We discuss the basics of establishing the orchard and selecting cultivars.

We describe organizational structures and financial considerations, plus feature two successful projects in the state.

Orchards can provide a setting that brings communities together for celebration and for more healthful living.

Let's get growing!





# Starting Your Orchard

## Selecting Your Site

The first step for success in a community orchard is to select the proper place. No spot in North Dakota is perfect. We all know this is a tough place to live for us and our plants. Use the information below to find the best spot for your community orchard and make adjustments as needed.

Fruit trees and shrubs demand full sun (at least eight hours per day) to flourish.

Fruit trees and shrubs need good drainage. Plants that sit in water for extended periods will suffer from root rot.

Orchards often are planted on slopes not suited for row crops. Avoiding low spots where frost accumulates is critical. A killing frost (28 degrees) in late spring can kill flower buds, which will eliminate your crop for that year. A killing frost early in fall will damage fruit before it is ripe.

Avoid the top of a hill because the plants will be fully exposed to strong winds. Plants on top of a hill may be subject to more hail damage and fire blight disease.

The exposure of the slope is important, too. A south-facing exposure experiences more temperature fluctuation than a north-facing exposure. Trees in a south-facing orchard are more likely to break their dormancy during a warm spell in late winter; then, when cold weather returns, these buds will be killed. Trees in a south-facing orchard are more likely to suffer sunscalding and cracking of their trunks in winter.

North- and west-facing slopes will be more subject to harsh winds. Winds can injure trees and cause ripening fruits to fall before harvest. A shelterbelt would be especially helpful in this situation.

As stated earlier, trees on a north-facing slope will be slower to bud out in the spring and thereby be less affected by late-spring frosts. This is beneficial, but trees on a north-facing slope may not get enough heat during the growing season to ripen the crop before the first killing frost in the fall. In this case, early ripening cultivars would be advised.

A community orchard should be easily accessible to the community it serves.

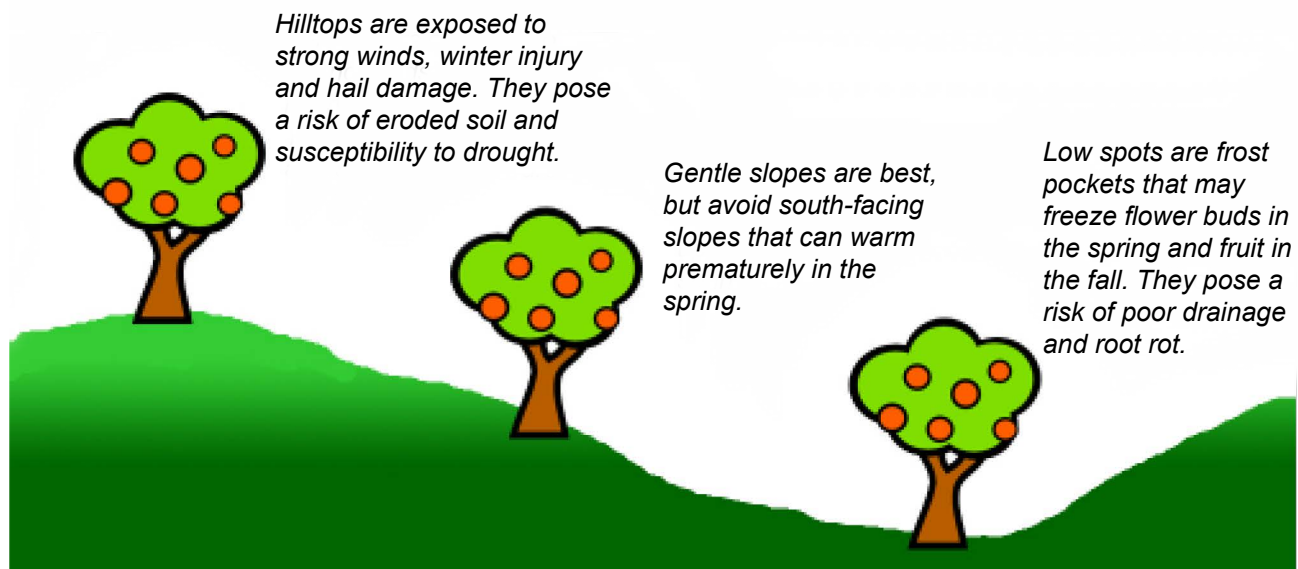

Figure 1. Considerations when selecting a site for your community orchard.

A community orchard is a major investment of time and money. A nearby source of water is required for at least the first two years.

Clean, cultivated areas away from brush favored by deer and other wildlife are preferred.

Now that we have found the ideal spot, we have to make sure the site is available and stays available. A common problem of community garden projects is their land is taken away from the project after a couple of years, often after the project has made significant improvements to the site. The long-term availability of the land with an orchard is even more critical because the fruit trees may not bear decent crops for a few years. A long-term agreement must be in place with the landowner (see Appendix 4) to ensure the work involved in establishing the community orchard bears fruit (literally) and does not go to waste.

## Preparing the Land

The land for a community orchard should be prepared the year before planting, if possible.

A soil test is a good idea. This will help you understand what nutrients are lacking and gives you the opportunity to make adjustments before planting.

The pH of the soil should be known and adjusted, if needed. Many soils in our state have a slightly alkaline pH (7.1 to 7.5). This is suitable for most popular fruits. A slightly acidic soil pH (6.5 to 6.9) is ideal because it will maximize the availability of nutrients to the plants. A pH above 7.5 will make growing popular fruit crops difficult because some nutrients will be locked in the soil and become unavailable to plants.

Phosphorus is important for the establishment of roots and flower buds, but it does not move easily within the soil. This makes phosphorus an especially important nutrient to adjust before planting the orchard.

Salty sites are not recommended. No plants like salt because the salt will desiccate roots. A few fruits, such as aronia, cherry plum, Juneberry and seaberry, are more tolerant to salt than others. Applications of compost or peat moss to the soil can improve the structure and moisture-holding capacity of salty soils. Mulching will prevent

evaporation and subsequent accumulation of salt. Also, planting on a slope where salty water does not accumulate can help. If possible, seek a better, less saline location.

In an urban area, you need to be cautious of the possible presence of lead from old paint or heavy metals from waste products. Old buildings or piles of debris should be warning signs. A soil test to evaluate the presence of heavy metals would be wise for this public gathering place.

## Buying Plants

Learn your hardiness zone (see Figure 2) and select good-quality plants from a reputable nursery (see Appendix 1). If possible, purchase trees that were grown at a northern nursery.

Soil conservation districts can provide inexpensive plants. In some cases, these are seedlings of plant species and not cultivars. For example, a seedling of hardy plum may be available, but not a 'Waneta' plum, a cultivar that was selected for superior hardiness, productivity, ease of care, resistance to disease, and/or flavor qualities.

If the goal of the community orchard program is to plant some fruit trees and share the fruit with wildlife, soil conservation districts can be an economical source of plants. On the other hand, if you are aiming to have a productive orchard with high-quality fruit, you will be better off in the long run to grow cultivars from commercial fruit nurseries.

Bare-root plants are less expensive than containerized plants but are available only in the spring and must be planted soon upon arrival. If the orchard is not prepared, the stock can be planted in a temporary trench in the garden. Bare-root stock is soaked two to four hours in water before planting.

Bare-root plants are highly recommended for strawberries, raspberries and other small fruits due to their affordability and ease of planting.



Figure 2. Plant hardiness zone map for North Dakota. Source: U.S. Department of Agriculture.

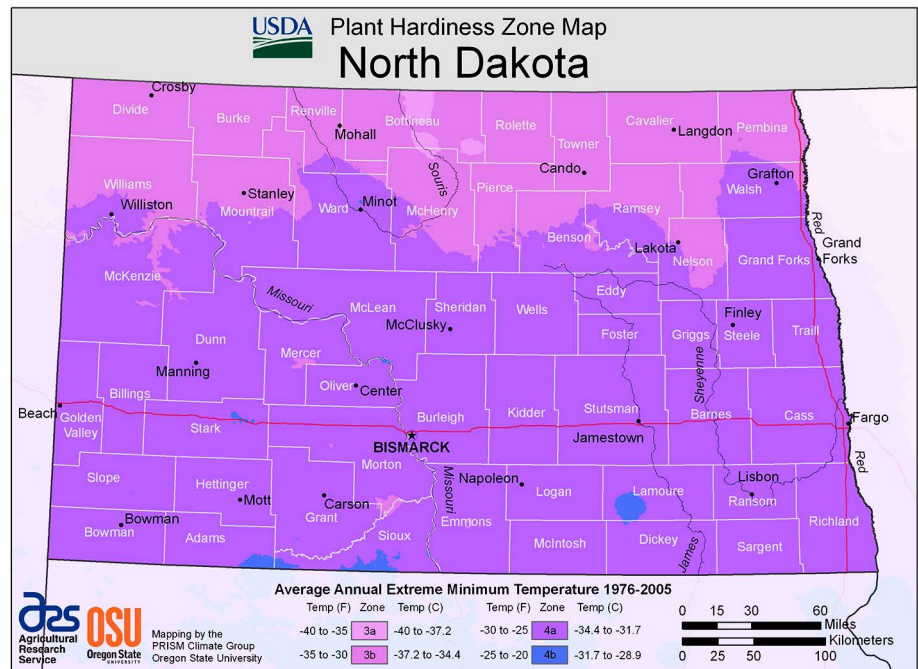

## Planting

Plant your orchard in the spring once the soil becomes dry enough to work. Before digging, consider whether you need to call the Diggers Hotline to avoid damaging underground utility lines.

When planting a tree, dig a wide hole that will allow the roots to spread out evenly without cramping or coiling within the hole. Roots can be lightly trimmed, if needed.

Planting depth is important. We generally plant trees and shrubs at a depth so the soil surface is about 1 inch above where the uppermost major roots (crown roots) appear on the trunk.

Graft unions of trees are located above the crown roots and should be planted above ground. If graft unions are planted below ground, you will reduce the dwarfing effects or other beneficial qualities of the rootstock.

Don't plant too shallowly: Crown roots should not be exposed. Don't plant too deeply: The tissue above the crown roots is stem tissue and is not meant to be belowground, where it can suffer from stem rot. We have a tendency to plant our trees and shrubs too deeply; maybe we are worried our Dakota winds will blow them away.

Do not add compost, manure or other soil amendments in the planting hole. The tree needs to get used to the native soil. If you add lots of amendments in the hole, the tree roots might like

the conditions in the hole so much that they never push out into the native soil. This is especially likely to occur in heavy clay soils. In this case, this is comparable to planting a tree in a clay pot; the roots will grow in a coiling pattern and eventually strangle the tree. In heavy soils, roughen the perimeter of the hole to help the tree roots break through the clay.

As you fill the planting hole with soil, gently but firmly tamp the soil over the roots. When the hole is about three-fourths full, pour a bucket or two of water into the hole to help the soil settle and to remove large air pockets. Then fill the remainder of the hole and water again.

Trees in established pastures sometimes are planted without cultivating the land. Prepare an area at least 3 feet in diameter before planting each tree (wider is better). Mulch after planting. Grass is a very aggressive competitor with trees, absorbing water and nutrients out of the soil. Keep the grass away from the trunk of the tree using cultivation or a grass-killing herbicide such as glyphosate. Do not use mowers or weed whips to control grass near young trees or you will risk damaging their bark and killing the tree.

For strawberries and raspberries, add a couple of inches of compost or rotted manure into the row before planting. Mix it thoroughly into the native soil to make a rich, well-drained bed. Just as in the case of trees and shrubs, plant berries so the crown roots are just below the soil surface.

## Pruning

If you purchased a tree with branches, do minimal pruning at planting time. Remove any broken branches. If two branches are rubbing against each other, trim out the least desirable branch. Start pruning and training the tree next spring.

If you purchased a nonbranched “whip” tree, cut the stem at 30 inches. This will stimulate the first flush of branches at this point.

## Fertilizing

Fertilizer is generally not needed at the time of planting (ideally, we will have corrected any major soil deficiencies before planting). Do not apply standard granular fertilizers in a planting hole because they can burn the roots. Wait to fertilize a newly planted tree or shrub for at least a couple of weeks.

Spring is the best time to fertilize. Do not fertilize after the Fourth of July because the new growth that results may not be winter hardy.

A good way to monitor the fertility of the soil is to see how much new growth you get each year. The annual growth of a tree can be seen as the glossy tissue from the tip of the branch to a dark scar that encircles the branch. Young fruit trees should grow about 18 to 24 inches per year and then about 10 to 12 inches when they reach fruit-bearing age. If you are not getting this type of growth, consider a soil test and fertilizer treatment.

## Watering

Watering is absolutely critical at the time of planting. Thoroughly soak the root area. Check on the plants every few days and make sure the soil below the surface never dries completely. Young trees need approximately 5 to 10 gallons of water per week when the weather is dry.

The orchard will need to be watered regularly until the plants have recuperated from their transplanting shock. This is at least two years. A weekly watering should be expected.

Water deeply. Roots will grow where the water is located. If you water deeply, the roots will grow deeper. Keep the foliage dry when watering to prevent foliar diseases. Watering in the morning is best; watering at night is worst because you encourage a humid environment that favors disease.

## Mulching

Mulch is especially important in North Dakota. Organic mulches, such as wood chips and shredded bark, will conserve moisture and reduce moisture stress on the young plants.

Organic mulches moderate soil temperatures. Mulches will slow warming of the soil in the spring, thereby delaying flowering and reducing the risk of frost damage to the buds. Mulches will moderate summer heat, keeping the roots comfortably cool.

Rock mulches never should be used in an orchard. They trap heat, accelerating bud break in spring (and potential frost damage), as well as creating excessive heat stress in the summer.

Mulch will reduce weed problems near the trees. Mulch also can serve as an effective barrier between the trunk and grass. Lawn mowers and weed whips are common killers of trees. The most precious tissue of a woody plant is the tissue just beneath its bark (this is where new growth originates). Keep your mower away from the trunk.

Follow the 3-3-3 rule when applying mulch. Set mulch in a ring at least 3 feet in diameter around the tree, 3 inches from the trunk and 3 inches deep. In this way, the mulch will serve as a reservoir and bring applied water toward the trunk. Avoid building mulch up against tree trunks because this could serve as nesting habitat for bark-biting voles or lead to stem rots.

Fruiting shrubs also will benefit from mulching. Keep the mulch minimal at the trunk and extend it out at least 18 inches to either side of the shrub. Organic mulches will need to be replaced periodically as they settle and decompose.

## Staking

Staked trees bear earlier and produce higher yields than unstaked trees. Staking will protect trees from damaging winds and keep the root system stabilized in the soil. Grafted trees especially will benefit from staking because it will prevent the scion from snapping off the rootstock.

A 10-foot-long, 3/4-inch-diameter electrical conduit pipe works well. Locate the pipe a few inches away from the trunk and pound it 2 feet into the ground at the time of planting. After several years, the pipe will rust at the soil surface. At that time, pound the pipe 2 feet down again. If you don't like to use a pipe, use 2- to 3-inch rounded wooden posts or 2-inch square pressure-treated lumber.

## Trellising

Raspberries (especially the vigorous purple raspberries) and some gooseberries will benefit from trellising. Permanent posts can be spaced 20 to 30 feet apart down the row. Cedar or pressure-treated posts, 4 to 6 inches in diameter and 6 to 8 feet in length, work well. Bury them at least 30 inches in the ground. Wrap heavy-gauge wire from post to post on either side of the posts, 42 to 48 inches above ground. The canes will grow between the wires. More complicated trellis systems are also available.

If raspberries are planted in hills, a metal or wooden post can be placed in the middle of each hill. Twine then is used to wrap the canes around the center post.

Grapes should be staked at the time of planting. A trellis should be constructed in short order to train the vines. Growers should seek technical advice in selecting the best trellis for their situation, giving consideration to the type of grape grown, management skills and amount of land available. The high-cordon system often is used to train the vigorous grape cultivars that commonly are grown in North Dakota. This system has one wire located 6 feet off the ground, running along the support posts. A second wire at 36 inches high commonly is added to support newly planted vines and retrained vines in the future.

## Wrapping and Painting

Fruit trees are sensitive to the scalding rays of the winter sun. Trees should be wrapped in fall to protect the trunks. White plastic spiral tree guards are an alternative. These wraps also protect against wildlife damage. Remove wraps in spring.

The trunks of trees should be painted with white paint to reflect the sun's rays. Use a 1-to-1 ratio of latex paint and water. Make sure you paint at least the south- and west-facing sides of each trunk.

*Fencing is the only sure way to prevent damage.*

## Managing Wildlife

Wildlife can destroy an orchard planting quickly. In North Dakota, we are most worried about voles, rabbits, deer and birds.

A good way to minimize problems with voles and rabbits is to reduce brushy areas near the orchard. Keep the lawn mowed regularly.

The trunks of the trees can be protected with a ring of hardware cloth wrapped around them. The cloth should be at least 2 feet tall with a mesh of 1/4 inch. Bury it an inch in the ground. Ideally, we should protect the trees up to at least the first branch.

Birds usually are controlled with nylon netting. Cherries and Juneberries are especially at risk. Place the netting before the fruit begins to change color. Scare devices such as one-eye plastic balls and plastic owls may work for a day or two, but the birds soon will learn these devices are harmless.

Chemical repellents that repel rabbits and deer temporarily are available. These will work when wildlife pressure is light. If wildlife pressure is aggressive, the only solution is fencing.

For deer, an 8-foot-tall fence is recommended. Fencing made with nylon is relatively affordable and will work for several years. Metal fencing is more costly but is a wise investment for an orchard with a long life expectancy. The first few years are most critical to help the orchard get established. Electrical fences are most reliable but usually not appropriate for a public orchard.

For rabbits, a 4-foot-high fence, buried a few inches in the ground, is recommended. The mesh should be 1/4 inch.





## Spraying

This can be a touchy issue in a community orchard. Nobody likes to use pesticides, but fruits are susceptible to insect pests and diseases. Have a policy in place before the planting is established. This policy needs to address whether chemical control is allowed in the orchard and whether this control must be exclusively organic.

In a public orchard, the minimal use of toxic chemicals is strongly encouraged. Whenever pesticides are sprayed, signs should be posted to alert the public.

An integrated approach is needed:

- Keep the plants in good health. Healthy plants are more likely to tolerate pests.
- Prune on a regular basis to open the plants to good air circulation and sunlight. Sterilize pruning shears between trees if diseases such as fire blight or black knot are in the orchard.
- Remove any rotting or fallen fruits in the orchard.
- Remove weeds, which harbor insect pests.
- Avoid overhead watering, which creates a humid environment for diseases.
- Select disease-resistant cultivars, if possible.
- Monitor your plants closely to detect the first signs of problems and then take action quickly.
- Use insect traps. Apple maggot traps, for example, can be hung in apple trees to monitor for the presence of the pest. If the pest is not there, you don't need to spray.
- Monitor the weather. Foliar diseases, such as apple scab, are most likely to occur when the spring season is wet.

Relatively safe products are becoming more commonly available. Copper sprays, including copper sulfate (Bordeaux mix), will control most diseases. Neem (azadirachtin), spinosads and pyrethrins are organic products that control many insect pests and are relatively safe. Products containing *Bacillus thuringiensis* (Bt) can control some types of insects safely and effectively. Some organic apple growers dust their trees with Kaolin clay to reduce feeding damage from insects.

Organic products are not necessarily safer than synthetic products. For example, malathion, a popular insecticide in fruit production, is less toxic than organic products such as rotenone or nicotine. Contact your local Extension office and/or local fruit growers for advice on controlling pests.



*Traps can be used for monitoring apple maggot flies, which lay eggs in apples.*



*Apple scab disease can be controlled with regular pruning, fungicide sprays and resistant cultivars.*



*Bacterial diseases such as fire blight can be managed with pruning and resistant cultivars.*

## Pruning and Training Young Trees

All fruit trees need to be pruned, and the best time is late winter (March through April). The tree is dormant and the wounds will heal quickly in the spring. Also, the tree is leafless and we can see the branches and their structure easily.

Pruning is needed to keep a tree healthy. This will bring more sunlight and air movement into the canopy, thereby reducing disease problems.

Pruning will keep a tree stronger. Remove the weak branches that cannot support fruit. This will create a structure that can stand up to the winds and blizzards of North Dakota.

Pruning will improve fruit quality. The increased sunlight in the canopy will brighten the fruit. The increased air movement will reduce pest problems, too.

Pruning helps us manage the tree. By keeping the tree low, we can spray (if needed) and harvest the fruit more easily.

On the other hand, unpruned apple trees produce low-quality fruit. Unpruned trees are more susceptible to diseases and storm damage. Unpruned trees are more likely to be attacked by insect pests; no one likes wormy fruit.

The major goal when pruning is to maximize the amount of sunlight and air movement in the canopy.

The most popular structure for fruit trees is the modified central leader. This structure has one major branch in the center and the widest part of the tree at the bottom, with the branches working their way up in a “Christmas tree” shape. To maximize the amount of high-quality fruit, the tree should not be taller than 16 feet (10 feet is better).

Pruning a fruit tree is not hard, but you have to take your time, constantly stepping back to make sure you see all of the angles.

Start by taking out the suckers that develop at the base of the trunk.

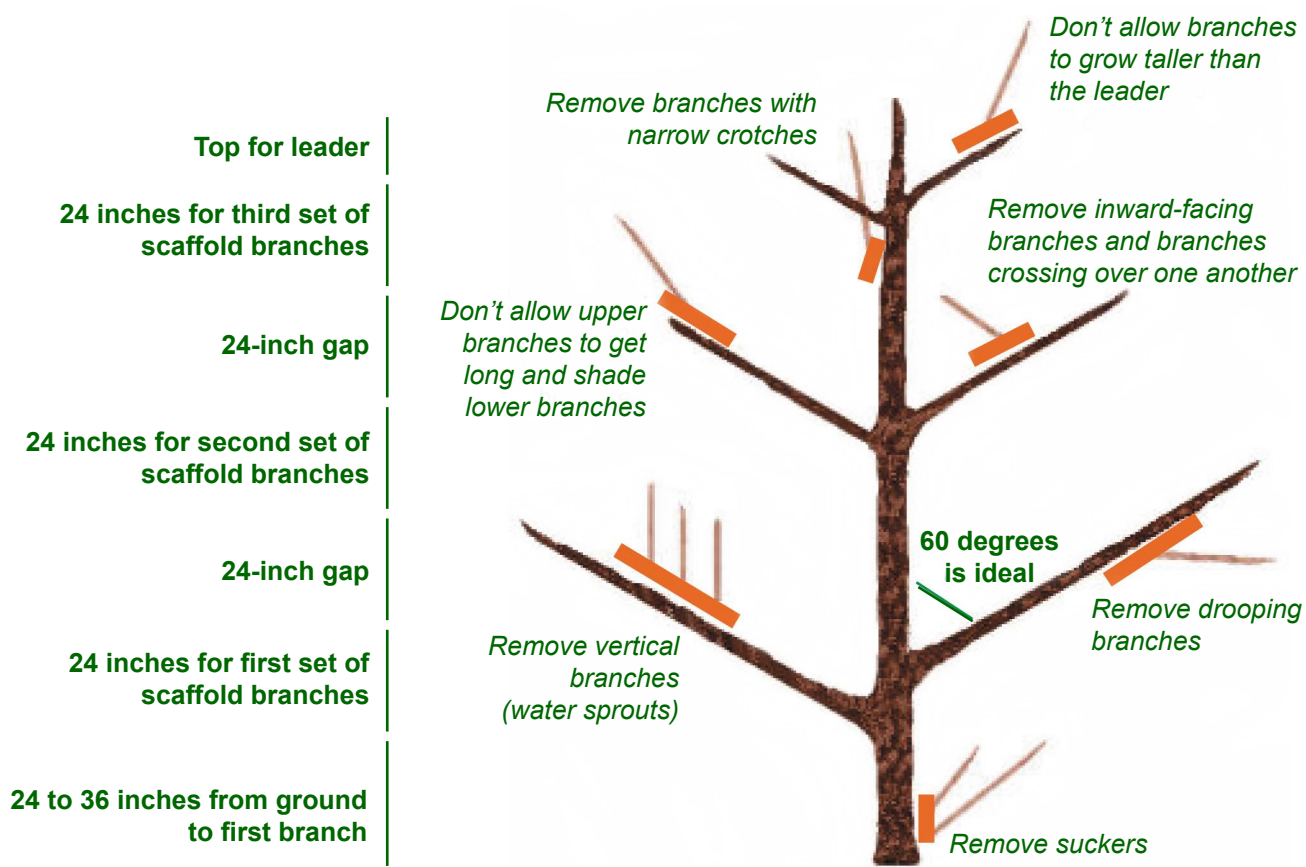

Figure 3. The basics of pruning fruit trees.

Fruit trees, especially apples and pears, have a tendency to develop vertical branches (we call them water sprouts). Water sprouts clutter the tree and do not produce fruit. Remove all the water sprouts.

That was the easy part. Now we have to think a bit. If the tree is 5 years old or younger, it still has time to develop the structure we like to see in healthy fruit trees. Be patient; this may take several years.

If possible, the first branch should begin about 30 inches from the ground. Ideally this branch will face the west or south to shade the trunk from the scalding rays of the winter sun.

In the next 24 inches, we will develop our first series of major “scaffold” branches. Four branches, each facing a different direction (north, south, east and west), would be ideal. Imagine viewing the tree from above. The branches coming out of the trunk should resemble spokes coming out of the hub of a wagon wheel.

Then develop a gap of about 24 inches between the sets of scaffold branches to maximize sunlight and wind movement.

Next, develop the second set of scaffold branches. As the tree grows, you may allow for another 24-inch gap and then a third and final set of scaffold branches. Allow a foot for the leader and you have a perfect tree.

Of course, nothing in nature is that perfect. These are principles only. Maybe you cannot have a gap between the sets of scaffolds; in many cases, you will have more of a steady progression of branches up the tree (keep adjacent branches going in different directions so they do not shade each other).

Look for branches with sturdy angles. Sixty degrees is best (some growers call these 10 o'clock and 2 o'clock branches). Branches with narrower crotches are less fruitful and subject to splitting.

Vertical branches do not produce fruit. Horizontal branches produce fruit but will droop from the weight of the crop. Also, horizontal branches will not generate the vegetative growth we need.

Remember to maximize air movement and sunlight in the canopy. Remove any inward- or downward-facing branches, which create shade pockets.

Remove the weaker of branches that cross over one another. They can rub against one another and create wounds. Remove any broken branches.

Try not to remove more than 25 percent of the tree's wood during any single year. If your tree has been neglected for a long time, a lot of wood needs to be removed, and getting it in shape will take a few years.

Most fruit growers use a lopping shears and hand pruning shears when pruning. A bypass shears will make cleaner cuts than anvil shears. A pruning saw sometimes is used after the tree is well established to remove large branches.

Never use wound dressings when pruning fruit trees. The wounds will heal faster if you leave them alone.

After the major branch structure is in place, we can develop the secondary branches.

We will make the cuts with our hand pruners, making the cuts just above a bud, allowing for a collar (see Figure 4). This will encourage healing and lead to more outward growth (less cluttering of the canopy). Prune to a bud that faces where you want the branch to grow; usually this is an outward-facing bud.

Don't leave stubs when pruning. These do not heal well and often lead to disease.

If you are not sure you are done pruning, keep pruning. Open the tree up. Create lots of windows for air and sun. Open up the tree and you will be rewarded with high-quality fruit.

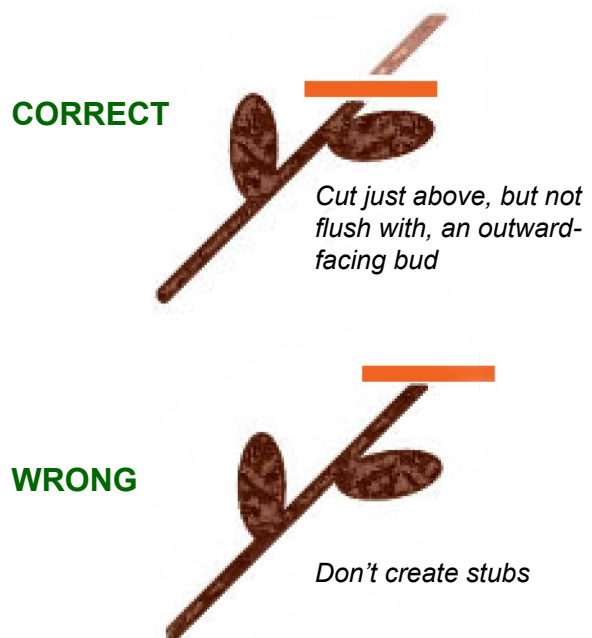

Figure 4. How to prune a small branch.



## Rejuvenating Old Apple Trees

North Dakota has lots of old apple trees. These trees are tall, rarely pruned and never sprayed. The trees provide some flowers in the spring, shade in the summer and a few decent fruits in the fall. It's nice, but we can do better.

If you prune the tree, you could have a healthier tree with more blossoms in the spring and fruits of higher quality in the fall.

To get better apples, you need to get more sunlight into the canopy. You also need to bring the tree down to size so you can manage and harvest the fruits more easily.

The ideal "Christmas tree" shape described earlier is going to be more difficult to develop in an already mature tree. After all, the leader may have grown 30 feet tall. In most cases, it's wise to go for an umbrella shape now, with branches cascading in all directions from the main trunk(s).

The tree has been neglected for years, and getting the tree into decent shape will take years. This first year, focus on reducing the height of the tree. The ultimate goal is to bring the tree down to about 12 feet tall.

The principles of pruning are the same as described earlier. Establish a network of sturdy branches, preferably at 60-degree angles from the trunk. Search for sturdy branches about 3 to 4 inches thick within the old canopy. Look for young, strong branches; these branches have glossy bark while old branches are scaly.

Once you identify a strong, young branch, trim above it to bring the tree down to size (Figure 5). To avoid sunscalding and shocking the tree, try not to remove more than 25 percent of the tree's wood at any one time. Giving yourself at least two years to reshape the tree is best.

Remove the clutter within the tree. Remove suckers, water sprouts, broken branches, and inward- and downward-facing branches.

This mature tree has an extensive root system and it will keep pumping a lot of nutrients and water to the branches. Expect lots of new shoots to appear this year. Aggressively trim out the vertical shoots the following spring. Also, take advantage of any new 60-degree branches that emerge and use them as future scaffold branches.

After about four years, you will see a big difference in the health of the tree and fruit production. But to be honest, you still have an old tree, and the best days of this tree are long gone.

Unless the tree is a special heirloom type or has historical value, the best long-term solution may be to remove the old tree. In the place of the overgrown tree, you could plant two apple trees (or perhaps add a cherry or plum), which will be properly trained. After six years, you will have superior yields of superior fruit, and the best days of your young, vigorous trees will be ahead of them — not behind them. The trees will be an attractive feature in your landscape, not a curious eyesore.

Some of us feel cutting down a tree in a prairie state such as North Dakota is a sin, but trees are renewable resources. Cutting down one tree and planting two in its place is OK. We can chip up the old tree to use as mulch for the new tree(s). Plus, we will have more fruits to share with our families. It's a win-win situation.

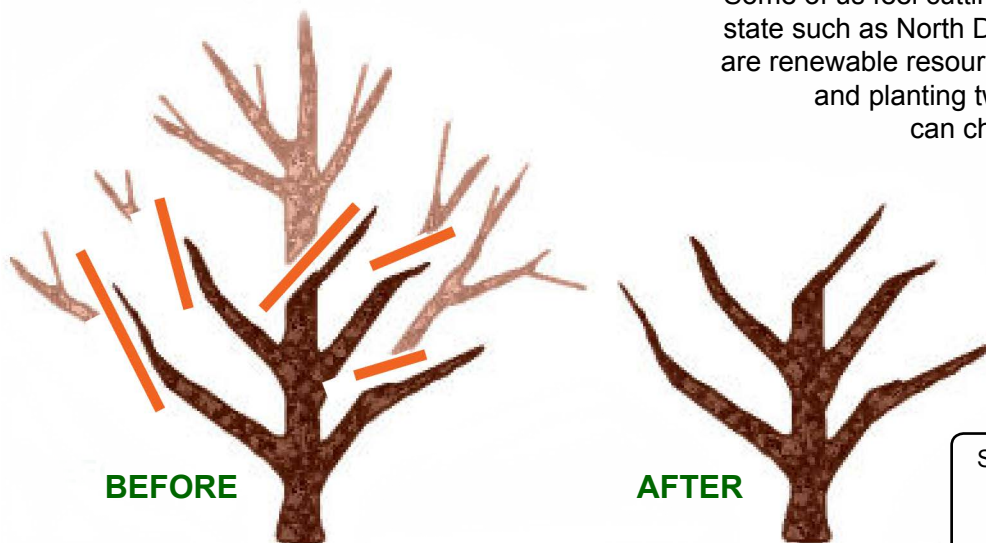

Figure 5. Pruning an overgrown apple tree.

Sources for this chapter include University publications from Cornell and Wisconsin (see Sources on last page).

# Fruits for North Dakota

Fruit production is difficult in North Dakota. Bitterly cold winters, strong winds, hailstorms, unexpected frosts, cool summers and irregular rainfall limit the production of fruit crops.

Selecting fruits and cultivars adaptable to our state will be critical for success. The first step is

to know your hardiness zone (Figure 2). This will be the biggest limiting factor in selecting the right fruits for your orchard.

The following are some of the most promising fruits and cultivars for our state.

Cultivars are listed in order of ripening.

## Tree Fruits

---

### Apple

Apple is the favorite fruit grown in the backyards of North Dakota. Look for cultivars that are hardy, mature early, and produce high-quality fruit. The earliest cultivars are generally good for fresh eating but do not store well. Later-ripening varieties store better, but they run the risk of never maturing before the snow flies.

Apple growers in Zone 4 should strongly consider a tree with dwarfing rootstocks, especially if snow cover is present during the winter. Trees with dwarfing rootstocks are easier to manage, bear earlier and are more productive. Staking is generally recommended to prevent dwarf trees from breaking at their graft unions.

Look for the hardiest rootstock available. Among the hardiest are Ottawa 3 and Bud 9, but these are not as commonly available as others. G30 from Cornell University is hardy and resists fire blight.

The introductions from Malling are most common in the marketplace, and M26 is the hardiest of this group. M7 has been widely planted in Midwest orchards for decades; it produces a freestanding tree. These rootstocks will create trees about 12 to 16 feet tall under normal growing conditions.

Dwarfing rootstocks are not hardy in Zone 3. These gardeners should grow “standard” trees with rootstocks of ‘Dolgo’ or ‘Antonovka’, and then prune aggressively to keep the trees 16 feet or lower in height.

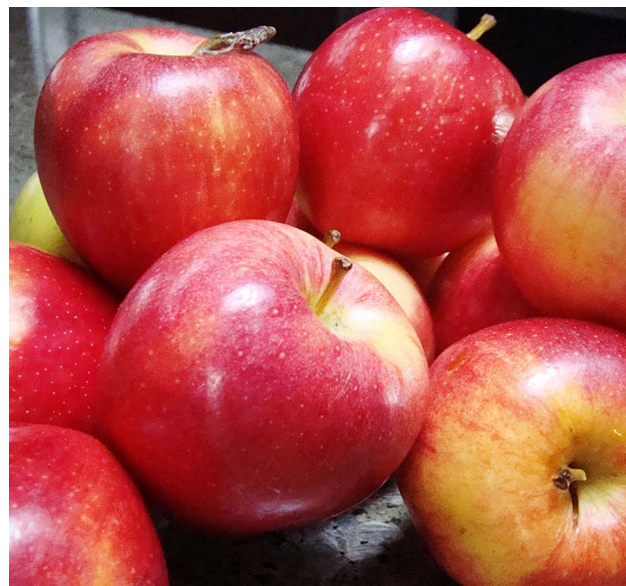

Apples are susceptible to many diseases and insect pests. Prevent diseases by pruning every year to open the tree to more sunlight and better air movement. Pick up fallen apples in fall. Use traps to monitor for insects such as codling moth and apple maggot.

The following are some of the best cultivars for North Dakota. All are hardy in Zone 3 unless noted otherwise:

## Apple (continued)

<b>CULTIVAR</b>	<b>FEATURES</b>
<b>Dakota Gold</b>	Large, yellow apple. Good for fresh eating, sauce and pies. Very hardy. Annual bearer. Tolerates fire blight. Ripens in late August. From North Dakota.
<b>Norkent</b>	Orangish fruit with apple-pear taste similar to 'Golden Delicious'. From Canada.
<b>State Fair</b>	'Mantet' x 'Oriole'. Bright red apple with crisp, juicy white flesh. Fresh eating. From Minnesota.
<b>Zestar!</b>	Excellent early apple. Crisper and better storage life than other early apples. Striped red skin. Marginally hardy in Zone 3. From Minnesota.
<b>Hazen</b>	Large, dark red fruit. 'Duchess' x 'Starking Delicious' parentage. Natural semi-dwarf (10 to 15 foot) tree. Does well without spraying. Mild flavor for fresh eating and cooking. Short storage life. From North Dakota.
<b>Duchess</b>	Popular apple from Russia. Medium to large size; mildly tart taste good for pies and sauce. Shows resistance to scab, rust, and fire blight. Ripens in early September.
<b>Wealthy</b>	Striped red apple with tart flavor. Precocious bearer. Ripens mid-September. Stores well. Heirloom from Minnesota.
<b>Goodland</b>	Medium-large apple; creamy yellow with blush of red. Ripens in late September and stores well. Flesh is crisp, juicy and aromatic. For fresh eating and especially good in pies. From Manitoba.
<b>Red Baron</b>	Medium-sized apple. Productive tree bears at a young age and tolerates fire blight. From Minnesota.
<b>Northern Lights</b>	Red with striped color pattern. 'Haralson' x 'McIntosh' parentage. Excellent, slightly tart flavor good for eating and cooking. Short storage life. From North Dakota.
<b>Prairie Magic</b>	Yellow with red blush. 'Goodland' x 'Mantet' parentage. Medium-large fruit is sweet and crisp. Vigorous tree. From Manitoba.
<b>Wolf River</b>	Very large apple. Yellow with red stripes. Used for cooking. Zone 4 only.
<b>Sweet Sixteen</b>	Medium-size, red apple with spicy-sweet, crisp, aromatic taste. Creamy yellow flesh. Good for fresh eating. Takes a long time to bear fruit after planting.
<b>Honeycrisp</b>	Most popular apple in Midwest. Sweet and balanced taste; very crisp texture. Exceptional for fresh eating. Large fruits ripen in late September to early October and store very well. Marginally hardy in Zone 3. From Minnesota.
<b>SnowSweet</b>	Bright white flesh that resists browning when sliced. Ideal for snacks. Shows some resistance to scab and fire blight. Zone 4.
<b>Haralson</b>	The standard for cooking apples in the Upper Midwest. Pleasantly tart flavor. Some resistance to fire blight. Easy to grow and stores well. From Minnesota.
<b>Wodarz</b>	Popular heirloom in North Dakota. Green, knobby "ugly" apple is very sweet and stores well. Shows some tolerance to fire blight. Late.



## Apricot

Apricots are loved as much for their delicate blossoms in the spring as their golden fruits in the summer. Apricots bloom very early so keep out of frost pockets and plant in a protected site. A north- or east-facing location will delay spring blooms and reduce the risk of frost injury. These cultivars are naturally dwarf and can be planted 10 to 15 feet apart. The Canadian cultivars are self-fruitful but produce better yields when more than one cultivar is planted. They are hardy to Zone 3. The Minnesota cultivars 'Moongold' and 'Sungold' should be planted together and are hardy to Zone 4.



CULTIVAR	FEATURES
<b>Moongold</b>	Large, light orange fruits. Sweet, sprightly flavor. Good quality. Blooms in late April and ripens in late July. Use 'Sungold' as pollinator. From Minnesota. Zone 4.
<b>Debbie's Gold</b>	Yellowish-orange fruit with firm texture and less sweet flavor. Freestone. For canning and fresh eating. From Alberta.
<b>Scout</b>	Gold fruit blushed with red. Flesh is tender, sweet and juicy. Freestone type. Good for desserts, canning and drying. Blooms in early May. From Manitoba.
<b>Westcot</b>	Large, freestone fruits. Mild, sweet flavor. From Manitoba.
<b>Brookcot</b>	Yellowish-orange with a red blush. Flesh is juicy with good flavor for fresh eating or canning. Semi-freestone type. From Alberta.
<b>Sungold</b>	Golden fruits with orange flesh. Freestone. Sweet, mild flavor. Blooms in late April and ripens in August. Use 'Moongold' as pollinator. From Minnesota. Zone 4.

## Cherry

Tart cherries are easy to grow and very hardy. Also called "pie" or "sour" cherries, they are used for pies, sauces, jams and breads. Ripe cherries are delicious to eat right off the tree, too.

Late-spring frosts can kill blossoms, so plant them out of frost pockets. Bird netting may be needed.

Pie cherry cultivars are self-fruitful. They are naturally dwarf and can be planted 10 to 15 feet apart. These tart cherries are hardy to Zone 3 unless noted otherwise. Sweet cherries are not hardy in North Dakota.



CULTIVAR	FEATURES
<b>Evans Bali</b>	Hardest tart cherry (Zone 2). Bright red cherries. Precocious and extremely productive. Introduced from Alberta.
<b>Sweet Cherry Pie</b>	Sweetest tasting sour cherry. Ripens in mid-July. Zone 4.
<b>North Star</b>	Deep red fruits with red flesh. Ripens in late July. Resists leaf spot disease. Introduced from Minnesota in 1950.
<b>Meteor</b>	Large, bright red fruit with yellow flesh and small pits. Vigorous tree is hardy. Fruit ripens 10 days after 'North Star'. Resists leaf spot disease. Introduced from Minnesota.

## Cherry Plum

Cherry plums were developed to survive the extreme weather of the northern Great Plains. They are extremely hardy (Zone 3), resist drought, and will bear fruit after one to two years. They grow as small trees 6 to 8 feet tall and can be spaced 4 to 8 feet apart.

They are self-unfruitful. Plant at least two cultivars for fruit set. The fruit is not as big or as delicious as most other plums. Fruits begin to ripen in late August.



CULTIVAR	FEATURES
<b>Red Diamond</b>	Dark red skin and flesh. Sweet and juicy.
<b>Sapalta</b>	Dull purple skin and flesh. Nearly freestone. Very productive.
<b>Compass</b>	Dark purple fruit with yellow flesh. Juicy flesh with sour skin. Good for jams and sauces.

## Crabapple

The tart flavor of crabapple makes it popular for canning and in making jellies. This fruit is grown just like apples.

A crabapple will pollinate an apple tree and vice versa. Most crabapples are partially self-fruitful but will produce higher yields in the presence of another apple or crabapple cultivar. These cultivars are hardy to Zone 3.



CULTIVAR	FEATURES
<b>Dolgo</b>	Russian variety popular for its bright white flowers and brilliant red fruits. The 1-inch fruits make good jelly. Tree resists scab and fire blight. Fruit ripens in late August.
<b>Centennial</b>	A progeny of 'Dolgo' and 'Wealthy'. Large (1.75 to 2 inches) fruit is one of the best for fresh eating. Red blush over orange skin. Short storage life.
<b>Whitney</b>	Large, yellow fruits with red stripes. The juicy, slightly yellow flesh is good for preserving and pickling.
<b>Chestnut</b>	Prized for its mildly tart, nut-like flavor. Fruits have a reddish-bronze skin and average more than 2 inches in diameter. The yellowish flesh is good for fresh use and desserts. Ripens in mid to late September.



## Peach

The flavor of a tree-ripened peach, bursting with juices all over your face, is one of the greatest taste experiences you ever could have. Peaches are not reliably hardy in North Dakota. Limit plantings to Zone 4 and in sheltered areas only (and have very low expectations). Keep the tree short and consider shielding it from winter winds by wrapping the branches with cord and burlap. Keep trees out of frost pockets to protect the blossoms in the spring. Space trees 12 to 15 feet apart.

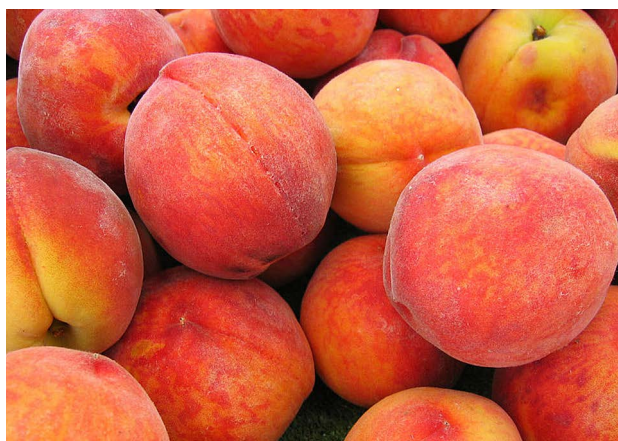

CULTIVAR	FEATURES
<b>Reliance</b>	Its hardiness makes it the most widely grown variety in the north. Bright yellow flesh is fairly soft and juicy. Fair flavor. Matures in early August. Self-fruitful. Grows 18 feet.
<b>Contender</b>	Freestone type with bright yellow, very juicy flesh. Outstanding flavor. Ripens in mid to late August. Self-fruitful. Grows 12 to 15 feet tall.

## Pear

The bright white blooms of pears in the spring are spectacular, but they are sensitive to frost. Pears are especially sensitive to fire blight disease, which is often introduced into a tree after hail (a common problem in North Dakota). Upright growth habit requires diligence in pruning. Cultivars below are hardy in Zone 4 unless noted otherwise. Two cultivars are needed for good yields.



CULTIVAR	FEATURES
<b>Early Gold</b>	A seedling of Ure displaying superior vigor and earliness. Matures in early to mid-August. Hardy in Zone 3. Use 'Ure' as pollinator.
<b>Golden Spice</b>	Small fruits have a tart, spicy flavor. Good for canning. Vigorous trees are very hardy (Zone 3). Excellent choice as a pollinator. From Minnesota.
<b>Ure</b>	Small, greenish-yellow fruit. Very juicy and sweet. Hardy (Zone 3). From Manitoba.
<b>Summercrisp</b>	Fruits should be eaten green when they have a crisp texture like an Asian pear. Ripe fruit is sweet. Some resistance to fire blight. Pollinate with 'Parker'. From Minnesota.
<b>Parker</b>	Seedling of a Manchurian pear. Large, bronze fruit with good eating quality. Fine grained, tender and juicy flesh. From Minnesota.
<b>Luscious</b>	Medium to small, bright yellow fruits. Dessert quality. Tree resists fire blight. Cannot pollinate other cultivars. Pollinate with 'Parker'. From South Dakota.



## Plum

Most plums are hardy but bloom very early in the spring, making the blossoms at risk of frost injury.

Blue (European or prune) plums are self-fruitful. Only one cultivar is needed and 'Mount Royal' is the hardiest. It is hardy only in Zone 4 and may experience dieback.

Other cultivars mentioned here are "red" or hybrid plums. These plums are self-unfruitful so plant at least two of these cultivars for good fruit set. 'Toka' is often used as a pollinator. Cultivars described here are hardy in Zone 3 unless otherwise noted.

Plums require little pruning and naturally grow 12 to 15 feet tall. Space them 10 to 15 feet apart.



<b>CULTIVAR</b>	<b>FEATURES</b>
<b>Black Ice</b>	Cross between cherry plum and Japanese dessert plum. Large, dark blue fruits with sweet, reddish-purple flesh. Compact growth habit. Zone 4.
<b>Underwood</b>	Red skin with golden yellow flesh. Clingstone type. Ripens early (mid to late August) and harvest continues throughout a long season. Very reliable.
<b>Waneta</b>	Very large fruit has yellow skin with a red blush. Clingstone type with sweet and juicy, yellow flesh. Very reliable.
<b>LaCrescent</b>	Small, yellow fruit with a red blush. Freestone type is very sweet and aromatic; excellent for eating fresh and for making jam. Does not store well. Vigorous tree. Zone 4.
<b>Toka</b>	Small-medium fruit with dark red skin. Flavor is rich and spicy. Clingstone type. Outstanding pollinator. Developed in South Dakota. Matures in late August.
<b>Pipestone</b>	Very large, red fruits. Tough skin will peel easily. Clingstone type with sweet, yellow flesh. Matures in late August.
<b>Alderman</b>	Large, burgundy-red skin. Clingstone type with sweet, golden flesh. Precocious tree is vigorous with a heavy bloom. Zone 4.
<b>Pembina</b>	Large, oval plum with red skin. Flesh is yellow and delicious; especially good for fresh eating.
<b>Superior</b>	Dark red fruits are large. Clingstone type with firm yellow flesh of outstanding quality. Tree has a somewhat weeping habit. Matures in early September. Zone 4.
<b>Mount Royal</b>	The most popular blue European cultivar. Juicy fruits are good for fresh eating. Clingstone type. Matures in early September. Hardier than other blue plums but less hardy than red plums. Self-fruitful. Will not pollinate red plums. Tree is a natural semidwarf. Zone 4.

# Small Fruits

---

## Aronia

Very productive and easy to grow. Also called black chokeberry, the fruits have a sharp, dry flavor and are usually not eaten raw. Europeans prize this American fruit for its nutrition (high in anthocyanins) and use it to make juice, syrups and preserves. Almost pest free, this fruit is popular among organic growers. Aronia is a beautiful ornamental shrub with white blossoms in the spring, showy dark purple berries in the summer, and brilliant red fall foliage. The multi-stemmed shrub grows 4 to 8 feet tall and is hardy to Zone 3. Space 4 to 6 feet apart. Tolerant to salt.



CULTIVAR	FEATURES
<b>Nero</b>	Compact, 4-foot shrub from Russia. Very productive.
<b>Viking</b>	Popular commercial variety in Europe. Vigorous, upright, 6-foot shrub bred in Sweden. Very productive.
<b>McKenzie</b>	Seedling strain from Bismarck. Grows 5 to 8 feet. Very productive.

## Blueberry

North Dakota is a terrible place to grow blueberries. Our soils are too alkaline, we do not get adequate snow cover, our winters are too cold, and our climate is too dry. Grow haskaps or Juneberries instead.

To grow blueberries, start with a soil test to know your soil pH. If your soil pH is 7.5 or lower, add sulfur to drop the pH down to 4.5 to 5.5. Spread peat moss over the site, building a 4- to 6-inch mound. Mix the peat moss and sulfur into the soil bed. Expect to add sulfur every few years.

If soil pH is 7.5 or higher, reducing the pH will be very difficult. You will need to grow blueberries in raised beds or containers using purchased topsoil and peat moss.

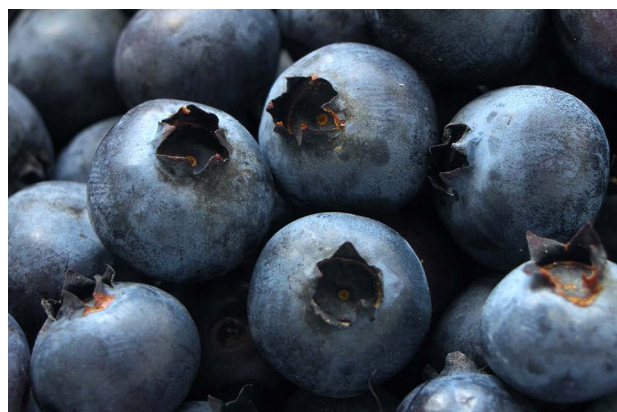

The following blueberries are hardy to Zone 4 and grow low (18 to 30 inches). Plant two cultivars for fruit set.

CULTIVAR	FEATURES
<b>Northcountry</b>	Sky blue berries are half-inch in size with a sweet, mild flavor. From Minnesota.
<b>Northblue</b>	Dark blue, large berries with good flavor. Good yields. From Minnesota.
<b>Northland</b>	Small, dark blue berries. Wild berry flavor. A hybrid from Northern Michigan.

## Currants

Currants are one of the world's most nutritious fruits. Black currants, in particular, have a tremendous following in Europe. Currants have a unique tart flavor and are usually used in wines, breads and jellies. Some cultivars serve as a host to white pine blister rust, but white pines are not common on our wind-swept prairies. Cultivars listed below show resistance to the rust. The multi-stemmed shrub grows 4 to 5 feet tall and is hardy to Zone 3. Space 3 to 4 feet apart in rows 6 to 8 feet apart. Among the most shade-tolerant fruits. Self-fruitful.



CULTIVAR	FEATURES
<b>Red Lake</b>	Its bright red berries make a beautiful jelly. Very hardy, vigorous bushes.
<b>Rovada</b>	Very large, glistening red fruits borne on long clusters. High yields. Blooms late to avoid spring frosts and ripens in late July.
<b>Titania</b>	Very large, black berries with milder flavor. Vigorous plants are hardy and resist mildew.
<b>Consort</b>	Its strong black currant flavor is good for jellies, juices and wine. Heavy bearing and precocious. Hardy Canadian cultivar. Susceptible to powdery mildew.
<b>Crandall</b>	Also known as clove or golden currant. Clove-scented flowers with mild fruit, good for fresh eating. Ripens in September.

## Dwarf Sour Cherry

Prairie cherries from Saskatchewan show great promise. They are extremely hardy (Zone 2), self-fruitful, and can be trained into trees or shrubs (minimal suckering). Fruits are large (nickel-size), dark maroon, and flavorful. Very productive. Shrubs grows 6 to 8 feet tall. Space 5 feet apart. Protect fruit from birds when ripening. Rabbit damage can occur during the winter. Plant 4 inches deeper than previously grown.



CULTIVAR	FEATURES
<b>Carmine Jewel</b>	Easy to grow. Good quality for cooking, juice, and fresh eating. Most tart. Suckering.
<b>Crimson Passion</b>	Extremely sweet, large fruits for fresh eating. Inconsistent production.
<b>Juliet</b>	Extremely sweet. More tender fruit. Productive.
<b>Romeo</b>	Sweet, large dark-colored fruit. Balanced sweet/tart flavor. Productive.
<b>Nanking</b>	Fast-growing, short-lived shrub from Asia. Dark red fruits have a sharp flavor suited for pies and jellies. Grows 6 to 10 feet tall and wide. Tolerates drought and alkaline soil. Plant at least two shrubs for pollination. Zone 2.



## Elderberry

This American native is hardy (Zone 4) and easy to grow. The creamy white flowers can be used in cordials. The dark purple fruits are processed into wines and jellies.

Cultivars have larger and sweeter fruits than wild elderberries but may not ripen in northern or central North Dakota. Plants from local soil conservation districts may be better suited to your local climate.

Elderberry prefers a rich, moist soil and grows 6 to 10 feet tall. Space 7 to 8 feet apart in rows 10 to 12 feet apart. Two cultivars are required for good yields. Canes are unproductive after three years; remove in the winter. Late ripening.



<b>CULTIVAR</b>	<b>FEATURES</b>
<b>Local</b>	Plants from your local soil conservation district may provide the greatest chance for success.
<b>Adams #1, #2</b>	Large fruits. Earliest to ripen (mid-August).
<b>Nova</b>	Large, sweet fruits. Plants grow 6 feet tall and are productive.
<b>York</b>	Largest fruits. The jet black fruits are juicy and sweet.

## Gooseberry

Native to the north, gooseberries are hardy and fairly productive. The thorniness of the bushes and their susceptibility to powdery mildew and other foliar diseases are concerns. This multi-stemmed shrub grows 3 feet tall. Space 4 feet apart in rows 6 to 8 feet apart. Hardy to Zone 3. Self-fruitful. Remove old canes to maintain vigor and productivity.



<b>CULTIVAR</b>	<b>FEATURES</b>
<b>Poorman</b>	Large green berries turn pink when mature. Productive, less thorny plants.
<b>Pixwell</b>	Productive variety from North Dakota. Pale green fruits become pink when mature. Mild flavor. Stems have short spines, but hanging fruits are easy to pick.
<b>Captivator</b>	Good yields of sweet, red fruit. Semi-thornless stems. Berries hang longer for easy picking. Resists mildew.
<b>Hinnomaki Red</b>	Beautiful, dark red fruits are delicious. Outer skin is tangy and flesh is sweet. Upright plants resist mildew. Very impressive and productive introduction from Finland.

## Grape

Grape growing in our state has been limited due to our frigid winters and short growing season. Select cultivars that ripen early and are hardy enough to survive winter without protection. Expect fruit to be tart most years. Cultivars are self-fruitful. Space 8 feet apart in rows 10 to 12 feet apart. Pruning and trellising required for optimal production. Hardy in Zone 4 unless noted otherwise. State growers' associations in North Dakota and Minnesota have helpful advice.



<b>CULTIVAR</b>	<b>FEATURES</b>
<b>Somerset Seedless</b>	The hardiest seedless grape for North Dakota. Rose-colored fruits are delicious. From Wisconsin.
<b>Kay Gray</b>	Early white grape for fresh eating or wine. Mild and fruity.
<b>Baltica</b>	Early red grape for wine. Requires fertile soil. Fairly susceptible to powdery mildew.
<b>LaCrescent</b>	Cold-hardy white grape for wine. Apricot and honey aromas. From Minnesota.
<b>Valiant</b>	Vines are productive and very hardy (Zone 3). Blue fruits grow in tight clusters. Susceptible to fungi in damp years or if not pruned. From South Dakota.
<b>Marquette</b>	A hardy wine grape. Small, blue-black grapes make a full-bodied red wine. Good resistance to diseases. From Minnesota.
<b>Petite Pearl</b>	Small clusters of red grapes for wine. From Minnesota.

## Hazelnut

Several organizations are developing superior cultivars and production strategies. Hybrid hazelnuts combine the hardiness and disease resistance of our native hazelnuts with the large size and superior flavor of European types.

Hybrid hazelnuts are hardy to at least Zone 4 and show tolerance to marginal soils and drought. The multi-stemmed shrubs grow up to 12 feet high and wide, and are spaced about 4 feet apart in rows. Their growth habit is similar to lilacs. At least two shrubs are needed for production.

Hybrid hazelnuts have shown no major insect or disease problems, but steps may be needed to exclude squirrels and crows. Shrubs start producing in 4 years and reach their peak after 8 years. Yields of 1–2 pounds per bush can



be expected. Plants and production tips are available from Riverbend Hazelnuts, Upper Midwest Hazelnut Development Initiative and Hybrid Hazelnut Consortium.

<b>CULTIVAR</b>	<b>FEATURES</b>
<b>Seedlings</b>	Cultivars are not yet available. Seedlings will show some genetic variation.



## Honeyberry

Honeyberries can be called the blueberries of the northern Great Plains. New Canadian cultivars (called haskaps) are larger, sweeter, and fleshier than blueberries or other honeyberries. This nonsuckering shrub grows 4 to 6 feet tall and is hardy to Zone 2. Widely adaptable to soils in North Dakota. Space 4 feet apart in rows 8 to 10 feet apart. Two different cultivars are required for fruit production.



CULTIVAR	FEATURES
<b>Berry Blue</b>	Tall, vigorous plant. Produces good crops of tasty berries. Excellent pollinator. From Russia.
<b>Indigo Gem</b>	Canadian haskap preferred for fresh eating. Tasty berries.
<b>Tundra</b>	Fruit is firm and does not bleed when harvested. Fruit may drop under windy conditions. From Canada.
<b>Aurora</b>	Good fruit. Often used to pollinize the Canadian cultivars listed.
<b>Borealis</b>	Very large, good tasting fruit. Popular for home gardens. From Canada.

## Juneberry

Native to North Dakota, Juneberries are hardy and tolerate slightly alkaline soil. The delicious fruits are prized by gardeners and birds alike; use netting to protect the ripening fruits. Blossoms are sensitive to late frosts in the spring; avoid frost pockets and south-facing slopes. Shrubs grow 4 to 18 feet tall and may spread 12 feet across. Plant more than one cultivar for better fruit set. Flower thrips, root aphids and fungal diseases are concerns.



CULTIVAR	FEATURES
<b>Martin</b>	A selection of 'Thiessen' with larger fruit size and more uniform ripening. Grows 12 feet.
<b>Thiessen</b>	Large fruit with mild, pleasant flavor. Grows 12–14 feet.
<b>Honeywood</b>	Slightly longer ripening period. A more flavorful berry. Compact, productive, 6-foot bushes.
<b>Smoky</b>	A standard cultivar in Canada, but its performance has been disappointing in North Dakota. Good yields. Well-branched plants grow 6 feet or taller. From Alberta.
<b>Northline</b>	Large fruits of superior quality. Productive plants grow 12 feet.



## Raspberry

Raspberry is a popular fruit that is easy to grow in North Dakota. Plant both summer- and fall-bearing types to extend your harvest.

Fall-bearing types bear fruit on their first-year canes. Select early-ripening cultivars only. You can mow the canes in April for a strong fall crop or allow the canes to develop and bear fruit during the summer. Summer-bearing types bear fruit on second-year canes, which are pruned out after harvest.

Raspberries are established to grow in hedgerows or hills. If hedgerows, set canes 2 feet apart in rows spaced 6 to 8 feet apart. Prune every winter to thin canes to stand 3 to 4 inches apart. If hills, set hills 4 to 6 feet apart in each direction. Prune in the winter to allow six to eight canes per hill.

Purple raspberry canes are pinched when 30 inches tall to encourage lateral branches and



these lateral branches are trimmed back to 18 inches long in the winter.

Trellising will make plantings easier to manage, especially the more vigorous purple types. The following cultivars are hardy to Zone 3 unless noted otherwise.

<b>CULTIVAR</b>	<b>FEATURES</b>
<b>Prelude</b>	Earliest raspberry. Good-quality fruits. Also bears a few berries in fall. Zone 4 only.
<b>Boyne</b>	Productive and very winter hardy. Medium-sweet berries good for freezing and desserts. Ripens in mid-July. From Manitoba.
<b>Killarney</b>	Large, bright red fruit. Excellent flavor and aroma. Good yields. Sturdy canes.
<b>Latham</b>	The standard red raspberry. Very reliable producer of bright red fruits. Good quality. Very hardy.
<b>Nova</b>	Good yields of firm, bright red fruits. Canes are vigorous, upright, and nearly thornless. Heat tolerant. From Nova Scotia.
<b>Jewel</b>	Hardest black raspberry. Tall, productive, vigorous canes produce shiny black fruit. Good flavor. Trellising is suggested. From New York. Zone 4 only.
<b>Encore</b>	Late-season berry. Large, cohesive fruits with good flavor. Sturdy, upright canes are almost thornless. Zone 4 only.
<b>Royalty</b>	Thorny canes produce excellent yields of large, purple berries in late summer. Excellent for freezing and jams. Use trellis. Zone 4 only. From New York.
<b>Polana</b>	Earliest fall-bearing type. Canes are very hardy and produce impressive yields of glossy red berries. Ripens in August. From Poland.
<b>Autumn Britten</b>	Improved fall-bearing type. Good yields of firm, large berries. Bright red. Good flavor. Canes are vigorous with few spines. Ripens in early September. Zone 4 only.
<b>Anne</b>	Large, flavorful yellow raspberry. Large, pale yellow berries ripen late in fall. Very sweet. Zone 4 only.

## Rhubarb

Although not a fruit, rhubarb is used like fruit in pies, sauces, jams and breads. It is a perennial crop more suited to a community orchard rather than a community vegetable garden, which is usually tilled every year. Rhubarb is very easy to grow and thrives in the cool temperatures of North Dakota. Prepare a sunny spot with a rich, well-drained soil. Space crowns 3 feet apart. Harvest stalks in the spring. These selections are especially hardy, at least to Zone 3.



CULTIVAR	FEATURES
<b>Canada Red</b>	Productive and sweeter than most. Smallish stalks with long, thick petioles. Dark red with light red interior.
<b>Crimson Red</b>	Plump, tender stalks. Balanced sweet/tart profile; excellent flavor.
<b>Valentine</b>	Thick, fleshy stalks that hold their rich red color when cooked.

## Seaberry

Bright orange clusters of berries adorn thorny branches with silvery foliage. Used in floral arrangements. The fruits are extremely nutritious and have an intense, citrus flavor. Most often is sweetened and diluted for use in juices. Very hardy (Zone 3) and tolerates salt, alkaline soil, sandy soil, and drought. The shrub grows 6 to 10 feet tall. Space plants 6 to 9 feet apart. Fruit-bearing female plants need a male pollinator (one male for up to eight female) and is pollinated by wind. This plant requires minimal pruning. Plant carefully as seaberry can be invasive.



CULTIVAR	FEATURES
<b>Orange Delight</b>	Reddish-orange fruits are very nutritious and have tropical fruit flavors. From Russia.
<b>Titan</b>	Russian cultivar produces large (blueberry size) fruits, making them easier for hand harvesting. Bright orange, less tart fruit. Reliable and productive.
<b>Leikora</b>	Standard German variety valued for its intense tart flavor and ornamental beauty. Ripens in late September.
<b>Hergo</b>	Small, light orange fruits. Widely planted in Germany. Branches are cut, frozen and shaken to remove fruits.

# Strawberry

June-bearing types are the easiest to grow. Choose an array of cultivars to spread your harvest from mid-June into mid-July. Space plants about 24 inches apart in rows spaced 36 to 42 inches apart. Remove the flowers the first year to help plants focus on establishment instead of using their energy to produce a few berries. The following year and for several years thereafter, you will have buckets of berries with minimal work.

Ever-bearing types send out a small summer crop and then one or two more flushes of fruits later. Day-neutral types produce a few berries all summer long. Neither of these types produces many runners, so space them closer, about 12 inches apart. Remove blossoms for the first six to eight weeks. These are less vigorous plants, and new plantings are established every two years. No



matter the strawberry type, mulch with a blanket of straw after the ground freezes. Cultivars listed below are hardy to Zone 3 unless noted otherwise.

CULTIVAR	FEATURES
<b>AC Wendy</b>	Very early. Large, bright red, delicious fruits. Risk of frost injury to blossoms.
<b>Earliglow</b>	Small, firm fruits with exceptional quality. Vigorous plants. Zone 4 only.
<b>Annapolis</b>	Large, attractive berries. Fair taste. Productive.
<b>Cavendish</b>	Dark red, firm, very large berries. Excellent taste. Extended harvest season. Good disease resistance.
<b>Honeyoye</b>	Very hardy and productive. Easy to grow and very popular. Attractive fruit is good for fresh eating and excellent for freezing. Tolerates leaf diseases.
<b>Mesabi</b>	High yields of large, delicious, scarlet-red berries. Excellent disease resistance package makes it especially good for low-maintenance plantings.
<b>Jewel</b>	Very large berries of excellent quality. Less hardy. Zone 4 only.
<b>Cabot</b>	Huge berries late in the season. Firm and flavorful. Zone 4 only.
<b>Sparkle</b>	Fruit is smaller but has excellent quality for fresh use and freezing. Very hardy.
<b>Ogallala</b>	Early ever-bearer. Rich flavor. Resists diseases and tolerates drought.
<b>Ozark Beauty</b>	Popular ever-bearer. Vigorous plants. Good berries for fresh use and freezing.
<b>Mara Des Bois</b>	Day-neutral type for containers. Berries are small but have exceptional gourmet flavor and fragrance. Zone 4 only.
<b>Seascape</b>	Productive day-neutral type; especially good for containers. Large, firm berries have good flavor. Zone 4 only.

Sources for this chapter include University publications from Minnesota, Montana and Wisconsin (see Sources on last page); and catalogs of Bailey's, Honeyberry USA, Jeffries, Jung, One Green World, Nourse, Raintree and St. Lawrence Nurseries.



## Chapter 4

# Starting Your Organization

## Structure

The concept of a community orchard in North Dakota began as a series of small, locally based projects, much like our community gardens and farmers markets did. In most cases, these projects started off with a series of meetings to discuss the objectives of their initiatives. As each project evolved, members gained new insights into how their organization could run most effectively.

A community orchard organization should be structured to encourage high levels of participation and impact. It should promote trust and transparency among its members and foster growth as an organization.

Bylaws are rules enacted by an organization to provide it with a framework for operation and management. These rules may specify the qualifications, rights and liabilities of membership. Powers and duties are specified, as well as grounds for the dissolution of the organization. See Appendix 5 for an example of a community orchard's bylaws.

Bylaws are required when an organization decides to become a nonprofit corporation. This step typically is done when an organization decides to take on major projects (such as a community orchard) and seek outside funding

and liability protection. Major projects bring with them some risk and some disagreements among members. A formal structure can help guide the organization through any turbulent times.

Formal bylaws should include the following:

- Official name of organization and legal address.
- Organizing members, names and addresses.
- The purpose, goals and philosophy of the organization.
- Membership categories and eligibility requirements.
- Membership dues, how much and when paid.
- Details on when and how often regular or special meetings of the membership are to be held, as well as regular and annual meetings of the board of directors.
- Description of what officers are necessary, how they are chosen, length of term, their duties and how vacancies are filled.
- List of any special committees, their purpose and how they operate.
- A system for bylaws to be rescinded or amended, perhaps by a simple majority.



- Any official policies or practices. For example, the group will not use synthetic pesticides; the group will donate fruits to the local food pantry; the group will maintain the orchard and keep it attractive.
- A “hold harmless” clause (sample):  
*“We, the undersigned members of the (name) community orchard group, hereby agree to hold harmless (name owner) from and against any damage, loss, liability, claim, demand, suit, cost and expense directly or indirectly resulting from, arising out of or in connection with the use of the (name) orchard by the orchard group, its successors, employees, agents, and invitees.”*
- Organizational dissolution processes.

## Liability

We live in a litigious society, and one accident can destroy a community orchard.

The community orchard organization needs to have an agreement in place with the landowner before the project begins (See Appendix 4 for an example).

Many landowners insist on protection from lawsuits stemming from accidents in the orchard. Pruning mishaps, falling off ladders, strained backs from carrying heavy loads, exposure to toxic pesticides and stings from wasps are just a few examples of accidents that can occur in a community orchard.

At the very least, a landowner can be protected partially by inserting the “hold harmless” clause mentioned earlier in the bylaws of the organization managing the project.

Even better, liability insurance can be purchased. Not all insurance agencies will offer this protection, but many major agencies will. Insurance agencies that work with social service agencies in the region may insure you. You also may call a pick-your-own farm in the area for guidance. Insurance firms that deal with many carriers may help you get the best policy at the best price.

In some cases, the landowner may provide liability protection to your group at no charge. This might happen when the community orchard is in a public park, school or other public place. For example, the activities of an orchard in a county

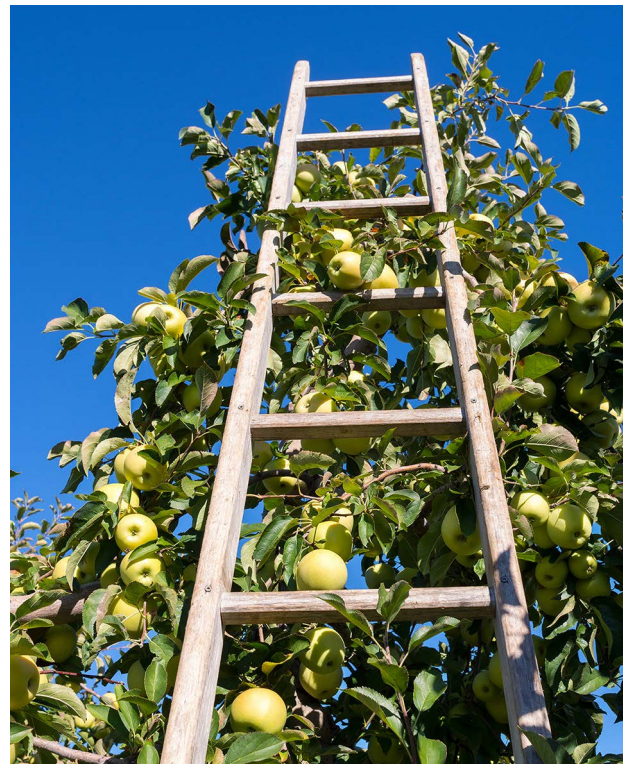

park may fall within the jurisdiction of the county government’s existing liability insurance policies.

If volunteers or people renting plots are working in the orchards, the organization may require the volunteer to sign the following agreement:

*“I understand that neither the (name) community orchard group nor (name owner) of the land are responsible for my actions. I, therefore, agree to hold harmless the (name) community orchard group and (name owner) of the land for any liability, damage, loss or claim that occurs in connection with use of the orchard by me or any of my guests.”*

The key is to prevent accidents. The community orchard group can place a warning sign at the entrance of the orchard. If toxic pesticides (organic or synthetic) are applied, people entering the orchard should be notified. Lessons on proper pruning and spraying techniques can be offered. Keep the heights of fruit trees as low as possible to reduce the need for ladders. Another way to reduce liability is to limit the dates and times the orchard is open to the public.

Source: The American Community Gardening Association



# Ten Steps to a Community Orchard



## 1. MAKE A PLAN

Organize meeting(s) to:

- Determine the main goals of the orchard (communal fruit production, renting plots, marketing, beautification, historic preservation, other, or combination thereof).
- Determine who the garden will serve (general public, food pantries, youth, other).
- Develop a leadership team and arrange for future meetings.
- Envision committees needed for the project (planning, fundraising, volunteer recruitment, other). Assign leaders, if ready.
- Develop a list of project priorities (site location, fundraising, volunteer recruitment, other).
- Develop an orchard identity (name, logo).

## 2. FIND A SITE

- Look for a sunny spot with well-drained soil and access to water. The land should be accessible to the public. An old farm or cultivated field is ideal.
- Avoid frost pockets and be wary of south-facing slopes.
- Identify the owner.
- Understand liability issues related to the property.
- Understand the history of the land: any contamination, waste dumping?
- Consult with your city or county local planning and zoning office to ensure there is no local statute that will create a conflict.

## 3. SIGN A CONTRACT

- Obtain a long-term agreement (10 years or longer is desired).
- Define liability issues for the project with the owner. Seek legal assistance if needed.

## 4. FIND MONEY

- Consider forming a 501(c)(3) nonprofit corporation.
- Pursue funding opportunities locally and nationally.
- Solicit donations from community organizations and businesses, including fruit nurseries.
- Establish contacts in the news media.
- Get a website and establish a social media presence to promote the project.
- Develop a plan to fund the orchard beyond establishment.

## 5. FIND HELPERS

- Identify sources of volunteers, including Master Gardeners, garden club members and youth groups.
- Identify local experts: fruit growers, NDSU Extension and North Dakota Department of Agriculture staff, local fruit nursery operators.
- Promote the project through the news media.
- Give presentations to community service organizations and garden clubs.
- Encourage neighbors of the site to get involved. Trade them fruits for their watchful eye.



## 6. DESIGN THE ORCHARD

- Consider project priorities.
- Select hardy fruits, preferably those resistant to diseases and insect pests.
- Understand your limitations of human resources and funding. Starting small and excelling is better (this will generate more community interest) than starting big and struggling (this will lead to frustration and burnout, and will lose community support).
- Gauge the level of commitment you have from your project team. Plan accordingly: Fruit trees will require a longer and stronger commitment to grow, compared with berries.
- Organic or not?
- Fencing?
- Storage area for tools?
- Beautify public entrances with flowers and other ornamentals.
- Plants requiring pesticide applications should be placed in less visible, low-traffic areas.
- Maintain adequate walkways.
- Determine rental plot areas, if any.

## 7. PREPARE THE ORCHARD

- Prepare written rules for renters and volunteers.
- Make a sign to let people know a community orchard will be established at the site.
- Clean the site.
- Kill existing vegetation, if needed.
- Cultivate the site.
- Outline beds for small fruits. Add compost or other organic matter to the beds.
- Lay out plots for renting, if any.
- Contact the news media on planting day to generate publicity.
- Plant, stake and mulch trees. Trellis other fruits, if needed.
- Start a watering program.

## 8. INVOLVE YOUTH

- Talk to local schools and youth groups. Youth will serve as positive ambassadors for the project.
- Invite neighborhood children to get involved. Give them ownership in the project; this will reduce vandalism.
- Consider establishing an area for youth plots.

## 9. MANAGE THE ORCHARD

- Encourage activities at the orchard; this will generate public interest and reduce vandalism.
- Establish contact people in case of emergency.
- Organize work crews and work days.
- Encourage volunteers.
- Monitor for disease and insect pest problems, weeds and wildlife damage.
- Use the website to keep everyone informed of the activities and needs of the project.
- Arrange for regular meetings of the leadership team at the orchard.
- Establish a plan for distributing the harvest.
- Contact the news media when the harvest season starts.
- Clean up the orchard and protect plants before winter arrives.
- Recognize volunteers and key project “friends” (sponsors) for their efforts.

## 10. REASSESS THE PROJECT

- Any new needs for the project to address?
- Future strategies for funding?
- Any new resources available? New support from sponsors may appear once they see the progress and “legitimacy” of the project.
- What worked and what didn’t?
- Changes needed in organizational structure or leadership?
- Organize an end-of-year meeting and celebration.
- Set a date for the next planning meeting.

Source: The American Community Gardening Association

# Featured North Dakota Orchards

## Aneta Community Orchard

The Aneta Community Orchard is a good example of a community rallying around a great idea and finding the local resources and talent needed to turn an idea on paper into a thriving orchard.

The orchard began with a \$7,000 grant from the North Dakota Department of Agriculture in 2012. The orchard's organizers realized the community had many resources to make the orchard a reality. An NDSU Master Gardener assisted in fruit cultivar selection and planting. Local farmers had equipment capable of breaking up ground that had been grass for many years. Farmers and local business owners with equipment, tools and skills in a variety of areas eagerly donated their time, directly involving the community in the orchard.

Key projects were completed early to ensure the sustainability of the orchard for years to come. Soil samples were taken to support optimum tree growth. Water lines were installed to make watering easier. Gravel was added to create a road to make it more accessible for workers, growers and the public. Most of the work was donated or completed at cost.

The 1.3-acre orchard is held in partnership with the Aneta City Council and Aneta Specialty Crop Group. The orchard is divided into two parts. A 0.3-acre sampling orchard offers more than 20 varieties of fruits identified and available to eat as a visitor walks the path. If visitors like what they eat in the sampling orchard, they can go to the larger orchard and find that variety and pick more. The large 1-acre orchard consists of a dozen apple trees, two apricot trees, two pear trees and two plum trees. Also as part of the orchard are 24 40-foot rows of small fruits and nuts. Most of the small fruits and nuts were planted by the local soil conservation district and have landscape fabric laid down. The entire orchard is surrounded by a large wildlife fence.



The community has embraced the project, and donations for the upkeep come from a variety of local sources. The local newspaper regularly writes stories about the orchard, which has allowed the community to follow its progress and hear of any needs the orchard may have. A Facebook page for the orchard was created to enhance communication. Community members have left money to the orchard as a memorial.

Five keys to success for this project:

1. Strong vision
2. Prioritizing tasks
3. Efficient use of local resources
4. Communication with public; and
5. Having a long-term plan.



# Prairie Dawn Community Orchard

Making the best out of a bad situation, the city of Sheyenne converted the grounds of the closed school into a community orchard using grant funds from the North Dakota Department of Agriculture (NDDA). Over the years as the orchard has grown, the once-barren land has again become a gathering space for the community.

The project first received funding from the NDDA in 2012 and again in 2015. The orchard has grown to more than 90 trees since its start in 2011. The orchard consists of several varieties of apples, apricot, cherry, pear and plum trees. The orchard measures 210-by-120 feet. A large perimeter fence was installed to help keep wild animals out and allow the trees to get established without disturbance. Water lines and spigots were installed at various spots inside the orchard to make watering easier. Benches were added to the orchard to create a park-like atmosphere.

One of the keys to success for the orchard was the committee clearly defining its goals and objectives. The city of Sheyenne, like many small North Dakota towns, was changing. The school closed in 2007, and the grocery store followed in 2008. The first objective was to repurpose the school grounds. The second objective was to provide the community with a local source of fresh produce now that the grocery store was gone. Adjacent to the orchard, more unused public land was repurposed for the creation of a community garden. Unlike some communities, the Sheyenne garden is one large garden, and everyone shares both the work and produce that is harvested. This was a separate project, and orchard grant funds were not used in the creation of the garden. A long-range goal is to utilize the orchard to provide fruit for the New Rockford-Sheyenne School.

The Sheyenne community orchard is a great example of a well-executed project. A strong group of community organizers developed a plan based on sound goals and objectives,



and followed through with their vision. The community supported the project by funding items not covered by the grant, and they volunteered their time. The community understands the need to constantly maintain the orchard with tasks like mulching, mowing and pruning to ensure the trees continue to do well. The city is looking forward and is prepared to continually invest in the orchard and find ways to make it even better for future generations.

Five keys to success for this project include:

1. Strong leadership
2. Long-term commitment
3. Community involvement and support
4. Clearly defined goals and objectives; and
5. Looking forward not back.



# Sources of Plants and Supplies

We encourage you to purchase plants from a northern source. There are over 250 licensed nurseries in North Dakota. A listing of these nurseries is available at [www.nd.gov/ndda/program/nursery-program](http://www.nd.gov/ndda/program/nursery-program). The following is a list of major companies selling orchard plants and supplies in the USA. This list of companies is provided as a convenience to readers. It is not an endorsement by NDSU Extension or the North Dakota Department of Agriculture, nor is it exhaustive. Plants and supplies may be available from other equally suitable companies.

Adams County Nursery  
Aspers, PA  
[www.acnursery.com](http://www.acnursery.com)

J.W. Jung Seed  
Randolph, WI  
[www.jungseed.com](http://www.jungseed.com)

Walden Heights Nursery  
Walden, VT  
[www.waldenheightsnursery.com](http://www.waldenheightsnursery.com)

Bergeson Nursery  
Fertile, MN  
[www.bergesonnursery.com](http://www.bergesonnursery.com)

Maple Valley Orchards  
Gillett, WI  
[www.maplevalleyorchards.com](http://www.maplevalleyorchards.com)

Woodstock Nursery  
Neillsville, WI  
[wallace-woodstock.com](http://wallace-woodstock.com)

Boyer Nurseries & Orchards  
Biglerville, PA  
[www.boyernurseries.com](http://www.boyernurseries.com)

Nourse Farms Inc.  
South Deerfield, MA  
[www.noursefarms.com](http://www.noursefarms.com)

Whitman Farms  
Salem, OR  
[www.whitmanfarms.com](http://www.whitmanfarms.com)

Farmer Seed and Nursery  
Faribault, MN  
[www.farmerseed.com](http://www.farmerseed.com)

One Green World  
Portland, OR  
[onegreenworld.com](http://onegreenworld.com)

Gilby's Nursery and Orchard  
Aitkin, MN  
[www.gilbysorchard.com](http://www.gilbysorchard.com)

Peaceful Valley Farm Supply  
Grass Valley, CA  
[www.groworganic.com](http://www.groworganic.com)

Fedco Trees  
Waterville, ME  
[www.fedcoseeds.com](http://www.fedcoseeds.com)

Raintree Nursery  
Morton, WA  
[www.raintreenursery.com](http://www.raintreenursery.com)

Hartmann's Plant Co.  
Lacota, MI  
[hartmannsplantcompany.com](http://hartmannsplantcompany.com)

Remick's Orchard  
Anoka, MN  
[www.remicksorchard.com](http://www.remicksorchard.com)

Henry Field's Seed & Nursery  
Aurora, IL  
[www.henryfields.com](http://www.henryfields.com)

Stark Bro's Nurseries  
Louisiana, MO  
[www.starkbros.com](http://www.starkbros.com)

Honeyberry USA  
Bagley, MN  
[www.honeyberryusa.com](http://www.honeyberryusa.com)

St. Lawrence Nurseries  
Potsdam, NY  
[www.stlawrencenurseries.com](http://www.stlawrencenurseries.com)

Indiana Berry  
Plymouth, IN  
<https://indianaberry.com>

Wafler Farms  
Wolcott, NY  
[www.waflernursery.com](http://www.waflernursery.com)



# Sample Budget

A community orchard may be as simple as planting a few trees in a pasture or as elaborate as establishing a public park. The following example is something in between. This one-acre orchard is a pleasant place to visit, a pleasant place to learn, and a pleasant place to grow fruit.

You enter the orchard through a doorway with flowers (see pink ovals) and Juneberry (a most ornamental fruit) in front. Plums, cherries and apricots are near the front; these early bloomers will attract interest to the garden in early spring and rarely, if ever, will need spraying. Visitors will walk toward an open area. This could be lawn in the beginning but eventually could hold a gazebo, sculpture or an outdoor classroom structure.

Beds of flowers (shrub roses, perennials and annuals) coax the visitor into the orchard. Grape trellises appear on either side. An area is dedicated to miscellaneous small fruits (haskaps, dwarf sour cherries, aronia, currants, gooseberries, other) to draw interest and use for demonstration purposes. Crabapples have ornamental value and will be placed near the orchard "gazebo." Pears and apples will be our tallest trees and will serve as the background planting.

Raspberries and strawberries may be grown for the community or rented to families. Similarly, any of the fruit trees could be rented to a family. Turf will be grown throughout the orchard, with soil beds prepared for the flowers and small fruits. A deer fence is installed around the garden. The following is an estimate of expenses:

Land preparation and turf seeding	\$2,000
Compost, mulch and its delivery	2,750
Trees (52 trees @ \$50)	2,600
Small fruits (200 raspberry, 150 strawberry, 108 miscellaneous, 20 Juneberry, 12 grape)	3,885
Flowers (50 shrub roses, other miscellaneous)	1,000
Tree protection (stakes, paint, hardware cloth, spiral guards)	600
Fence (7.5-foot black nylon)	3,000
<b>TOTAL</b>	<b>15,835*</b>

\*Does not include labor costs (volunteers), and ongoing watering and fertilizer costs.

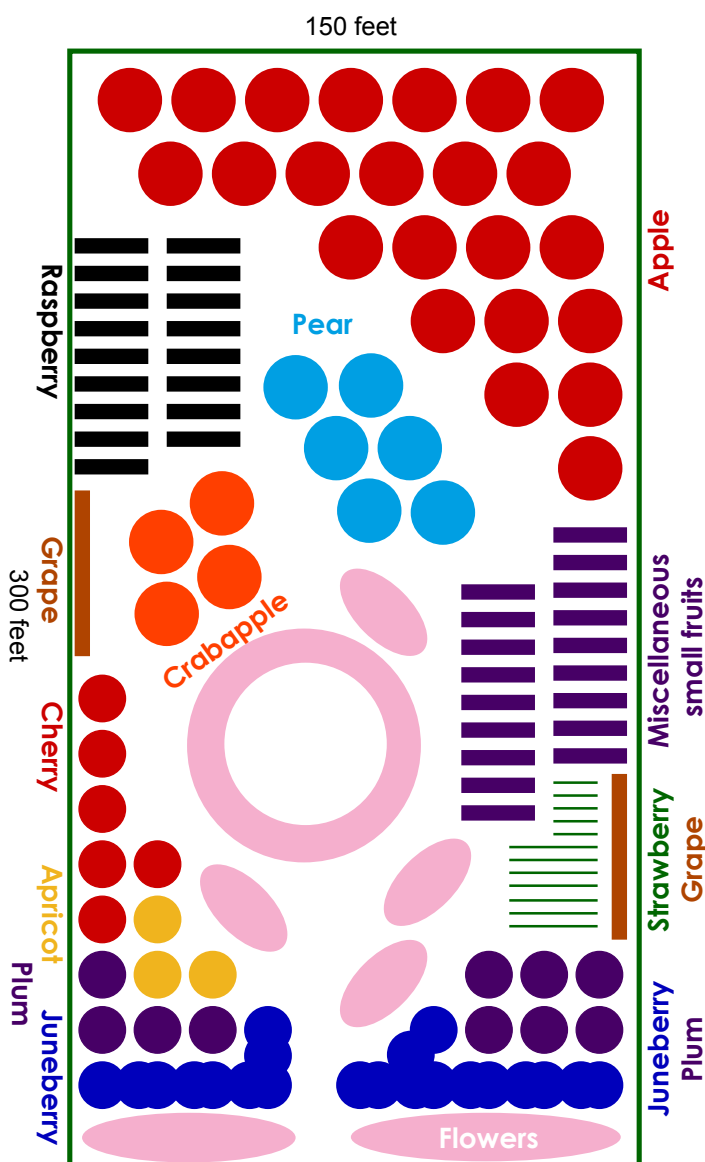

# Funding Opportunities

Many foundations, businesses and community organizations sponsor local projects. The following is a sample of funding sources relevant to community gardens and orchards. These sources are listed as a convenience for readers. Inclusion in this list is not an endorsement by NDSU Extension or the North Dakota Department of Agriculture, nor is this list exhaustive.

## **North Dakota Department of Agriculture Community Orchard Project**

*Who May Apply:* Schools and other community groups

*Amount:* \$500 to \$7,500

*Contact:* go to [nd.gov/ndda](http://nd.gov/ndda) and search community orchard project

## **North Dakota State University Junior Master Gardener Program**

*Who May Apply:* Youth groups including 4-H clubs, schools, churches, and other community organizations

*Amount:* Up to \$1,000 each

*Contact:* [www.ag.ndsu.edu/jrmastergardener](http://www.ag.ndsu.edu/jrmastergardener)

## **National Gardening Association's Youth Garden Grant Award**

*Who May Apply:* Schools interested in starting or renewing a garden or orchard

*Amount:* \$500 in materials

*Contact:* [kidsgardening.org/garden-grants](http://kidsgardening.org/garden-grants)

## **Green Education Foundation Green Thumb Challenge Grant**

*Who May Apply:* Schools and youth garden programs that have demonstrated impacts in the lives of kids and their community

*Amount:* \$250

*Contact:* [www.greeneducationfoundation.org/greenthumbchallengesub.html](http://www.greeneducationfoundation.org/greenthumbchallengesub.html)

## **Sustainable Agriculture Research and Education (SARE)**

*Who May Apply:* Researchers, educators, non-profits, farmers and youth

*Amount:* Typically between \$500 and \$15,000

*Contact:* [www.sare.org/grants](http://www.sare.org/grants)

## **Otto Bremer Foundation Grants**

*Who May Apply:* 501(c)(3) organizations in Minnesota, North Dakota and Wisconsin involved in the right to food, environmental rights, and the right to participate in cultural affairs of the community

*Amount:* Unspecified

*Contact:* [www.ottobremer.org](http://www.ottobremer.org)

## **Simply Organic 1% Fund**

*Who May Apply:* Projects that research, develop, teach or promote organic agriculture

*Amount:* Unspecified

*Contact:* [www.simplyorganic.com/community/about/giving-back/grant-application](http://www.simplyorganic.com/community/about/giving-back/grant-application)

## **Organic Crop Improvement Association Research & Education Micro Grants**

*Who May Apply:* Projects that support research or education in organic agriculture

*Amount:* \$300 to \$1500

*Contact:* [www.ocia.org/research-education/micro-grants](http://www.ocia.org/research-education/micro-grants)

## **Building Sustainable Farms, Ranches and Communities**

*Who May Apply:* This is a publication for anyone seeking help from federal programs to support innovative enterprises, including community gardens and orchards.

*Contact:* [www.attra.ncat.org](http://www.attra.ncat.org)



## Appendix 4

# Sample Contract for Land Use

*The following form is intended as a guide only; be sure that the final agreement you use meets the needs and details of your group and the property owner.*

I, \_\_\_\_\_ give permission to \_\_\_\_\_  
(property owner's name) (community orchard project)

to use the property located at \_\_\_\_\_ as a community orchard  
(site's street address)

project, for the term of \_\_\_\_ years beginning \_\_\_\_\_ and ending \_\_\_\_\_.  
(start date) (ending date)

This agreement may be renewed with the approval of both the property owner and the community orchard organization at the end of the agreement period. All questions about the community orchard, including its nature, risks and hazards have been discussed with the orchard coordinator to my satisfaction.

The community orchard agrees to indemnify and hold harmless the property owner from all damages and claims arising out of any act, omission or neglect by the community orchard, and from any and all actions or causes of action arising from the community orchard's occupation or use of the property.

As the property owner, I agree to notify the community orchard organization of any change in land ownership, development, or use 90 days prior to the change in status.

\_\_\_\_\_  
Property owner's signature

\_\_\_\_\_  
Community orchard coordinator's signature

\_\_\_\_\_  
Date

\_\_\_\_\_  
Date

Source: The American Community Gardening Assn.

# Sample Bylaws

*The following are the bylaws adopted by the Bloomington Community Orchard in 2010. These bylaws serve only as an example of how a community orchard organization may structure itself and is not necessarily an endorsement of this organization or its structure. Organizations in North Dakota may find it helpful to use these bylaws as a framework and then modify them accordingly.*

## Bloomington Community Orchard Bylaws

Adopted unanimously at the Annual Meeting

April 12, 2010

### Background

Amy Countryman's proposal to the City of Bloomington served as the catalyst for a Community Orchard idea coming together with land, funds and volunteers. The City donated land near the Willie Streeter Community Garden, across from the YMCA, and \$2000 to launch the project, but did not want to take on long-term maintenance or cost. Over one hundred community members attended an initial planning meeting. Many expressed the desire to live sustainably and develop community relationships. Out of a subset of these volunteers, came these governance ideas.

### Goal

The goal of the community orchard is to grow food-producing trees that the community feels safe to eat, whose fruit is available without cost and the City of Bloomington does not feel obligated to manage.

### Scope

While several in the Orchard Community have expressed support for many community orchard sites, the City's support has been extended specifically for the Winslow Woods site and is being run under the auspices of the City of Bloomington's Park and Recreation Urban Forester. Good governance and participation may provide support for further community orchard opportunities.

### Governing Board

The Community Orchard Governing Board is comprised of 9 elected members. Decisions about the orchard are made by this group with input from the Orchard Community.

The board can create subcommittees. Any powers of the board can be delegated to a subcommittee. Any delegated powers can be revoked by the board.

### Orchard Community

The Orchard Community is made up of volunteers that have contributed at least 2 hours to the orchard planning or maintenance or who have donated at least \$50 in a calendar year.

Volunteer hours are tracked on an honor system with any other community member verifying.

### Election to Board

Any member of the Orchard Community is eligible to become a board member. In-person voting will take place at a Community Orchard Annual Meeting. Electronic and mail votes will be allowed up until the Annual Meeting.

Each member of the Orchard Community is allowed one vote. Children capable of making an informed and independent decision are eligible to vote. The candidates that receive the most votes are chosen to represent the orchard.

The standard term for a board member is two years. Board members can be reelected. In the first election, the top 5 vote-receiving candidates will

be assigned 2-year terms and the next 4 vote-receiving candidates will be assigned 1-year terms to avoid having all board seats come open at the same time.

## **Decision Making**

Meetings in which decisions about the Community Orchard are made should be published in advance to the Orchard Community and open to public attendance. This includes both board meetings and subcommittee meetings. Meetings may or may not allow for public comment.

A quorum of 7 board members must be present for decisions to be made. Where technology allows for remote attendance, it is allowed. Decisions are approved if two-thirds of the board attendees vote in favor of the decision. Decisions can be made via email if board chooses to do so. There is no voting by proxy. Community input should be sought.

## **Commitment of Board**

Board meetings will be held every other week during the planning of the orchard, moving to monthly after first planting.

If a board member misses two consecutive meetings without consent of the board, they are assumed to have voluntarily resigned and their board position becomes open for election. The newly elected person will serve the remainder of the vacated term.

## **Changing Governance**

The Community Orchard may find that the governance rules need to change. Changes to governance will be made at Annual Meetings and voted on by Orchard Community with two-thirds approval.

The Community Orchard Governing Board can create temporary changes in governance rules in the time between annual meetings to meet the needs of good governance. These changes will be brought to the Orchard Community at large for a vote at the next annual meeting.

If the Orchard Community is unhappy with the actions of the Community Orchard Governing Board, they may, with signatures equal to 10 percent of the attendees of the last Annual

Meeting, call for a referendum to either change board members or governing rules.

## **Board Positions**

The board should choose among its elected members at the first meeting after the Annual Meeting, someone to serve as the Facilitator, the Assistant Facilitator, the Secretary and the Treasurer.

The Facilitator is responsible for creating an agenda, convening the meetings, and facilitating the meetings to ensure they run smoothly. The Assistant Facilitator is responsible for the duties of the Facilitator when the Facilitator is absent and serves as the liaison to any subcommittee that does not have an appointed board member appointed as its liaison. The Secretary is responsible for communication of the meeting times to the Orchard Community, for recording meeting minutes and the votes of any meeting, and performing any board correspondence needed.

The Treasurer is responsible for paying for all items approved by the board and accounting for all monies spent.

The board is responsible to make sure communication to the community and financial accounting take place. This group can choose to do it themselves or ask someone to take care of these responsibilities.

## **Design**

Design of an orchard that is sufficiently diverse and capable of producing with the minimum amount of intervention requires careful planning.

The board is encouraged to consult advisors that have knowledge in these areas.

## **Finance**

A Community Orchard Fund has been set up within the Bloomington Tree Fund. Donations for a Community Orchard at Winslow Woods can be made to this fund.

Funds can be spent on anything that directly or indirectly supports the Community Orchard Goal. Expenditures should be approved by the board or its delegates.



# Sources for Technical Advice



## North Dakota State University Extension

---

North Dakota State University (NDSU) Extension offers numerous resources to assist community orchards:

NDSU publications on managing fruit crops provide science-based, nonbiased information for orchards in our state.

The Master Gardener program can be a valuable source of technical advice and volunteer labor.

The Junior Master Gardener Program has resources to incorporate a youth education component into a community orchard.

The NDSU Yard and Garden Report provides regular updates on emerging pests and other issues related to fruit and other horticultural crops. The latest report is available at [www.ag.ndsu.edu/yardandgardenreport/](http://www.ag.ndsu.edu/yardandgardenreport/).

Several NDSU regional Research Extension Centers conduct research on fruit crops and have demonstration plantings available for viewing. The center in Carrington has an extensive collection of fruits (especially small fruits), and the vineyard in Williston is well established.

These and additional resources from North Dakota State University can be accessed through local county educators and regional horticulture educators. Local NDSU Extension offices are listed online and in the government section of local phone books. Go to [www.ag.ndsu.edu/extension/](http://www.ag.ndsu.edu/extension/) for more information on the publications and programs offered by the university.

## North Dakota Department of Agriculture

---

The North Dakota Department of Agriculture is a source for grant funding, local food programs and licensed nurseries. Updated lists of local sources for tree stock are available at [www.nd.gov/ndda/program/nursery-program](http://www.nd.gov/ndda/program/nursery-program).

## Other

---

The North Dakota Grape and Wine Association is an active supporter of fruit production in the state. It has an impressive network of growers who can provide technical assistance and conduct educational meetings on a regular basis. They can be contacted at [www.ndgwa.org](http://www.ndgwa.org).

The Natural Resources Conservation Service offers assistance to community programs and individual growers who foster productive lands and healthy ecosystems.

Sustainable Agriculture Research and Education (SARE) offers grants and outreach programs to farmers and educators to advance sustainable farming systems.

Local city or county foresters are valuable resources.

Employees at local garden centers and nurseries have knowledge on local gardening practices and pests.

# Hunger Free North Dakota Garden Project

It may take several years for an orchard to reach full production. What is your plan once it does? One great way to give back to your community is to consider donating some of the extra produce grown to a charitable feeding organization in your area through the Hunger Free North Dakota Garden Project administered by the North Dakota Department of Agriculture.

Many people do not realize that food pantries will accept fresh fruits and vegetables. More and more, pantries are seeing an increased demand for perishable foods by their clients. These pantries are answering the call by installing refrigerators to properly store any perishable food items they may receive.

If you are considering donating fresh fruits and vegetables to a local food pantry, call ahead to make sure your donation does not go to waste. Three good questions to ask are:

- When will someone be available to accept the donation? In some cities, food pantries may only be open certain days or hours of the week. Leaving perishable food “on the dock” to be picked up later can jeopardize the quality and is a food safety concern.
- How much can you use at one time? Donating perishable food may require you to stagger harvesting and making more trips to the food bank, but this will ensure less food spoils and gets wasted.
- Are there certain types of produce that are in demand? This is extremely helpful in the beginning of the season if you are planting extra produce intended for future donation. As a grower, you can anticipate and plant what is needed most.

Helping your neighbor in need is something good you can do for yourself and your community. Calling ahead helps to ensure quality food gets from the orchard, field or garden to those who need it the most, in the most efficient and safe way possible.

To learn more about the Hunger Free North Dakota Garden Project, and to find participating organizations in your area, visit [www.nd.gov/ndda](http://www.nd.gov/ndda) and search Hunger Free North Dakota Garden Project.



*Community groups and gardeners are donating fresh fruits and vegetables to local food pantries.*

## Sources

---

- American Community Gardening Association. 2016. Ten steps to starting a community garden. <https://communitygarden.org/resources/10-steps-to-starting-a-community-garden/>.
- Centers for Disease Control and Prevention. 2012. North Dakota State Nutrition, Physical Activity, and Obesity Profile. Division of Nutrition, Physical Activity and Obesity. Washington D.C.
- Common Ground. 2011. Apple Day: Community orchards. [www.commonground.org.uk/apple-day/](http://www.commonground.org.uk/apple-day/).
- Eames-Sheavly, M., M.Pritts, et al. 2010. Cornell guide to growing fruit at home. Cornell Cooperative Extension. Ithaca, NY.
- Gough, R.E. 2007. Juneberries for Montana gardens. Montana State University Extension. Bozeman, MT.
- Hoover, E. and M. Zins. 2011. Fruits for Minnesota. University of Minnesota Extension. St.Paul, MN.
- Roper, T.R. 2001. Rootstocks for fruit trees in Wisconsin. University of Wisconsin-Extension. Madison, WI.
- Roper, T.R. and G.G. Frank. 2004. Planning and establishing commercial apple orchards in Wisconsin. University of Wisconsin-Extension. Madison, WI.
- Roper, T.R., D.L. Mahr, and P.S. McManus. 2006. Growing apples in Wisconsin. University of Wisconsin-Extension. Madison, WI.
- Smith, B.R., D.L. Mahr, P.S. McManus, and T.R. Roper. 2007. Growing raspberries in Wisconsin. University of Wisconsin-Extension. Madison, WI.
- Smith, B.R. and T.R. Roper. 2005. Home fruit cultivars for northern Wisconsin. University of Wisconsin-Extension. Madison, WI.
- U.S. Department of Agriculture. 2019. 2017 Census of Agriculture Report. North Dakota State and County Data. Washington D.C.

## Photo Credits

---

The following are adapted from photos made available under Creative Commons licenses specified by the photographers, all allowing for adaptation, modification or building upon. Prefixes of photo URLs are “www.flickr.com/photos” unless noted otherwise:

COVER photos: left side, top, middle and bottom photos – Kathy Wiederholt, CREC; remaining photos – iStock.com; TABLE OF CONTENTS: Sergiu Bacioiu, .../sergiu\_bacioiu/4381745986/; PAGE 1: London Permaculture,./naturewise/4552716168/; 7: David~O, .../8106459@N07/5153638100/; 8: blogs.cornell.edu/jentsch/scouting-reports/; Clemson University - USDA Cooperative Extension Slide Series, Bugwood.org; Tom Kalb, North Dakota State University; 12: Vegan Feast Catering, .../veganfeast/4086510397/; 14: Max Westby,.../max\_westby/4341437/; KitAy, .../kitpfish/562254367/; 15: donkeycart, .../donkeycart/3144738323/; Larry Krause, .../clickclique/905971805/; 16: Bryan Costin, .../bcostin/28109150/; Boris Mann, .../boris/407687/; 17: fishyfish\_arcade, .../fishyfish/423065357/; 18: outdoorPDK, .../21202718@N00/4076481649/; BlueRidgeKitties, .../blueridgekitties/4792274594/; 19: Monika, .../17989497@N00/619721775/; soundingblue, .../klam/304135034/; 20: Mark Robinson,.../66176388@N00/3861843057/; John Haslam,.../foxypar4/704162819/; 21: picdrops, .../picdrop/2807676/; Hybrid Hazelnut Consortium, hybridhazelnutconsortium.blogspot.com; 22: Morigen at the Japanese language Wikipedia; Meggar at the English language Wikipedia; 23: Marko Kivelä, .../marko\_k/217468630/; 24: Cory Doctorow, .../doctorow/2318431953/; Beentree, commons.wikimedia.org/wiki/File:Hippophae\_rhamnoides1\_beentree\_bialowieza.jpg; 25: Estelle Pizer, .../estellephotos/3192063729/; 26: Sustainable Flatbush,.../sustainableflatbush/3639392468/; 27: iStock.com; 28: soundingblue, .../klam/304135034/; 30: North Dakota Department of Agriculture; 31: North Dakota Department of Agriculture; 32: Lucy, .../inial-t/2303531705/; 38: Morigen at the Japanese language Wikipedia; 39: Jeff Ellingson; BACK COVER photos: iStock.com.













NDSU Extension does not endorse commercial products or companies even though reference may be made to tradenames, trademarks or service names.

NDSU encourages you to use and share this content, but please do so under the conditions of our Creative Commons license. You may copy, distribute, transmit and adapt this work as long as you give full attribution, don't use the work for commercial purposes and share your resulting work similarly. For more information, visit [www.ag.ndsu.edu/agcomm/creative-commons](http://www.ag.ndsu.edu/agcomm/creative-commons).

**For more information on this and other topics, see [www.ndsu.edu/extension](http://www.ndsu.edu/extension)**