

Note: CORRAL ARRANGEMENT SIMILAR TO BELOW MAY BE INSTALLED FOR WORKING CATTLE. IF SCALE IS INSTALLED, USE FOR BOTH CATTLE & FEED

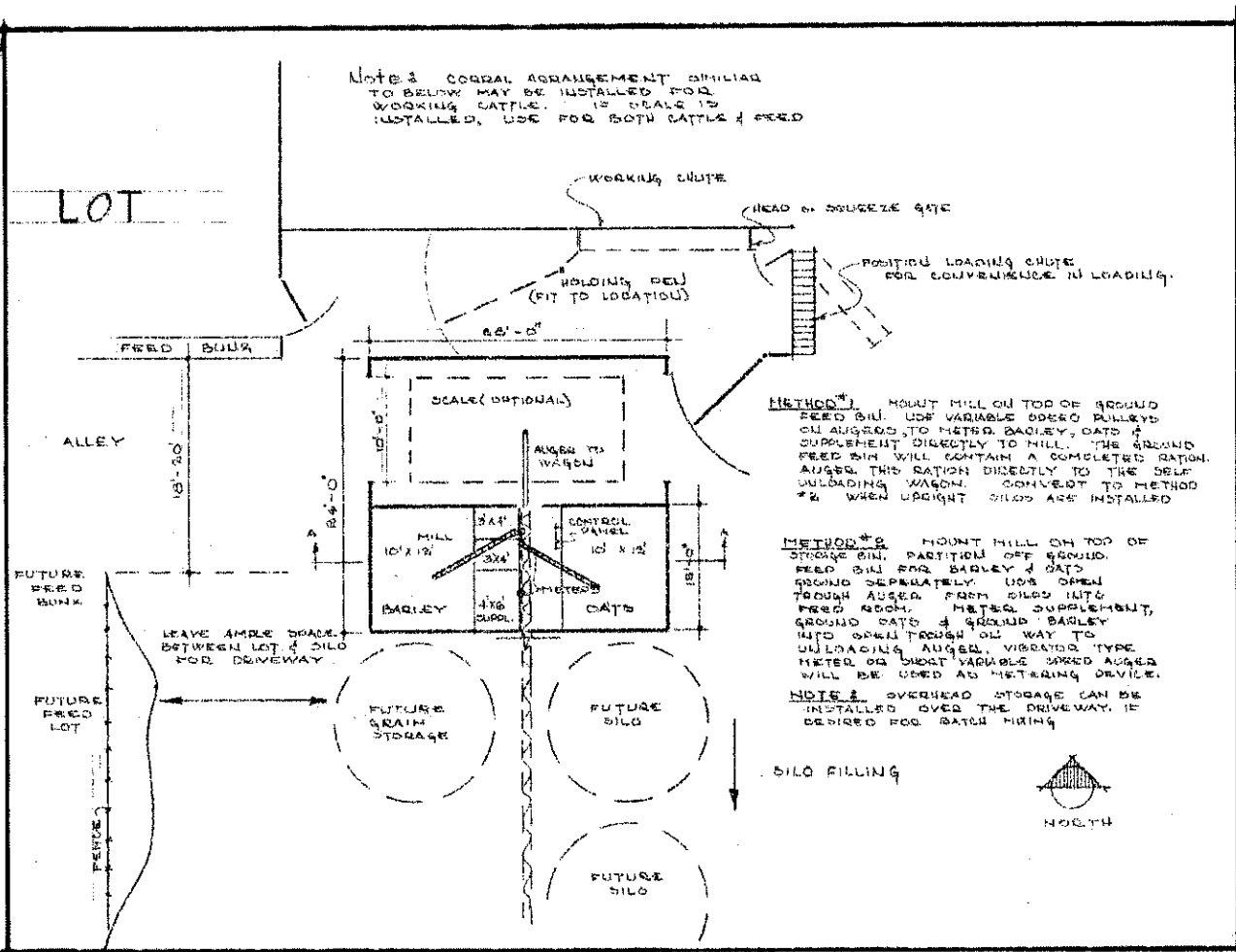

**METHOD #1** MOUNT MILL ON TOP OF GROUND FEED BIN. USE VARIABLE OVERHEAD PULLEYS OR AUGERS TO METER BARLEY, OATS & SUPPLEMENT DIRECTLY TO MILL. THE GROUND FEED BIN WILL CONTAIN A COMPLETED RATION. AUGER THE RATION DIRECTLY TO THE SELF UNLOADING WAGON. CONVERT TO METHOD #2 WHEN UPRIGHT SILOS ARE INSTALLED

**METHOD #2** MOUNT MILL ON TOP OF STORAGE BIN. PARTITION OFF GROUND FEED BIN FOR BARLEY & OATS GROUND SEPARATELY. USE OPEN TROUGH AUGER FROM SILO INTO FEED ROOM. METER SUPPLEMENT, GROUND OATS & GROUND BARLEY INTO OPEN TROUGH OR WAY TO UNLOADING AUGER. VIBRATED TYPE METER OR SHOT VARIABLE SPEED AUGER WILL BE USED AS METERING DEVICE.

**NOTE #1** OVERHEAD STORAGE CAN BE INSTALLED OVER THE DRIVEWAY. IF DESIRED FOR BATCH MIXING

SILO FILLING

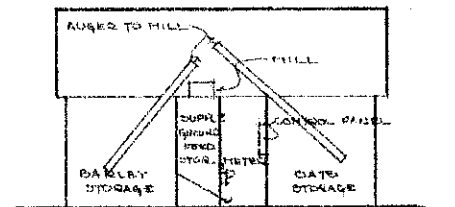

SECTION A-A

SCALE 1/2" = 1'-0"

FEED HANDLING LAYOUT

SCALE 3/4" = 1'-0"

FEED HANDLING LAYOUT			
JOHN BECKSTRAUD WARWICK		SCALE	DRAWN BY JONES
PREPARED BY AG. ENG. DEPT.		DATE	REVISED
DATE	APPROVED BY	DRAWING NUMBER	
June '65	N.D. 758-1-9	1 of 1	