

ND 734-6-3 544 of 8
 U.S. DEPARTMENT OF AGRICULTURE
 BUREAU OF PLANT AND SOILS AND AGR. ENGINEERING
 DIVISION OF FARM BUILDING & RURAL HOUSING
 PARK RIVER (ND) POTATO CO.
 BOX 248 150000 BU POTATO STORAGE
 TRACED BY: R.H. CHECKED BY: A.D.E.
 EAST GRAND FORKS, MINN. JULY 1932

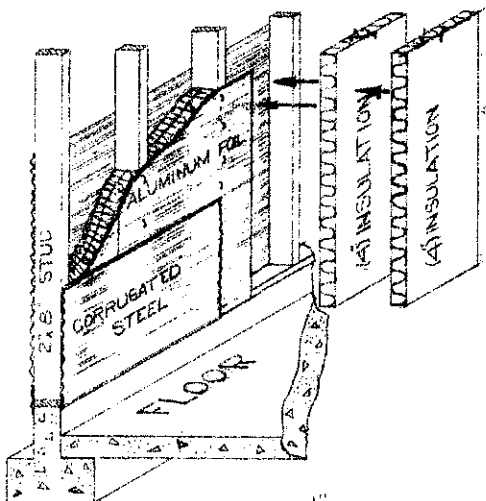

STAPLE SINGLE SHEET ALUMINUM FOIL TO 2x6 STUDS, PAPER SIDE TOWARD INSULATION
PLACE CORRUGATED STEEL OVER FOIL

SCALE $\frac{1}{8}'' = 1'-0''$

WALL INSULATION VIEW

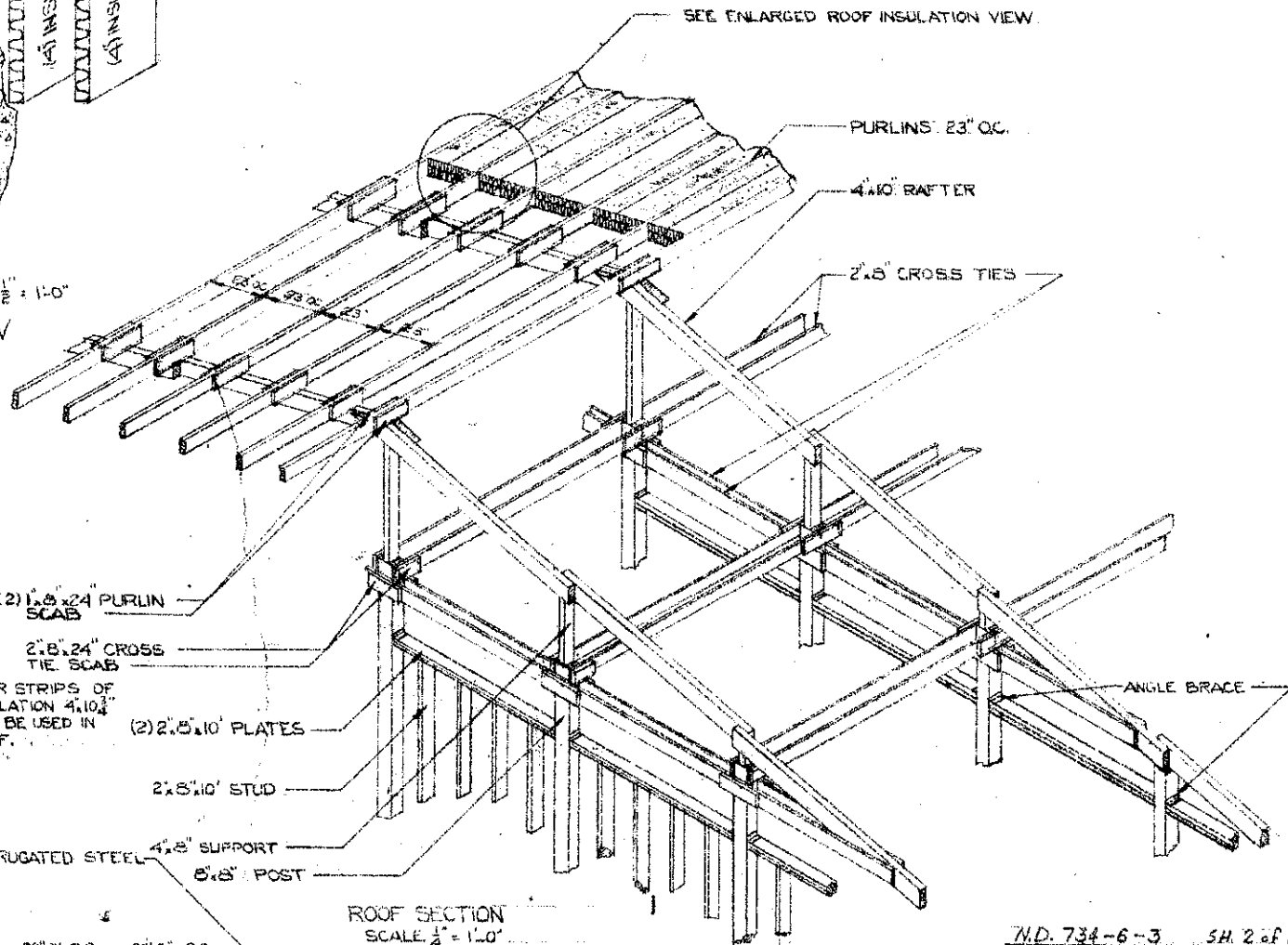

SEE ENLARGED ROOF INSULATION VIEW

PURLINS 23' O.C.

4x10 RAFTER

2x8 CROSS TIES

(2) 2x8x24 PURLIN SCAB

2x8x24 CROSS TIE SCAB

FOUR STRIPS OF INSULATION 4x10x1/2" WILL BE USED IN ROOF.

(2) 2x8x10' PLATES

2x8x10' STUD

4x8 SUPPORT

6x8 POST

ANGLE BRACE

ROOF SECTION
SCALE $\frac{1}{4}'' = 1'-0''$

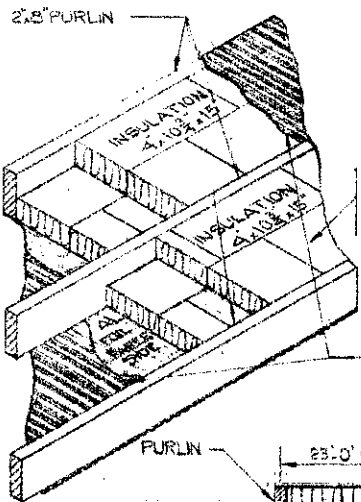

ROOF INSULATION VIEW
SCALE $\frac{3}{4}'' = 1'-0''$



N.D. 734-6-3 SH 2 of 2
U.S. DEPARTMENT OF AGRICULTURE
BU OF PLANT IND SOILS & AGG ENGINEERING
DIVISION OF FARM BUILDING & RURAL HOUSING
PARK RIVER, N.D. POTATO CO.
80x24x15, 150,000 BU POTATO STORAGE
TRACED: R.H. HANES CHECKED: A.D.E.
EAST GRAND FORKS, MINN. JULY 24, 53