

FLOOR PLAN

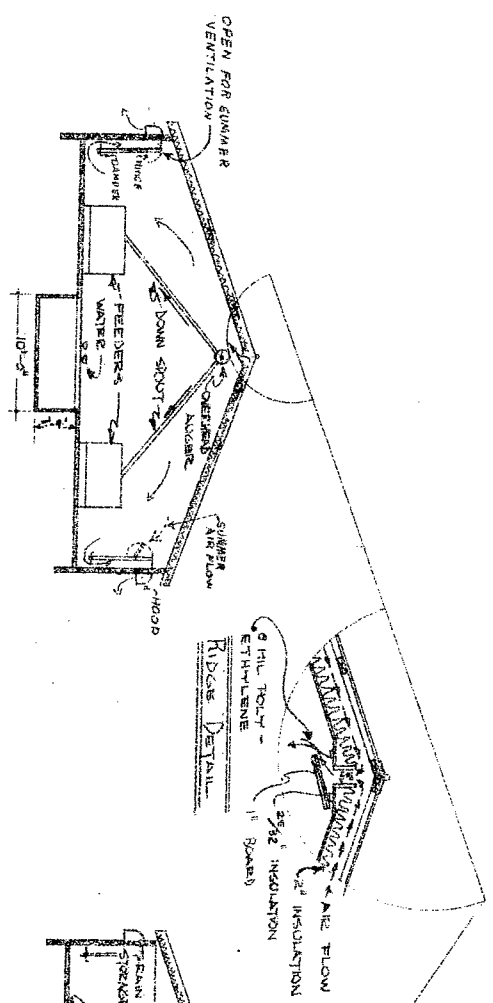

SECTION THROUGH FINISH SIDE

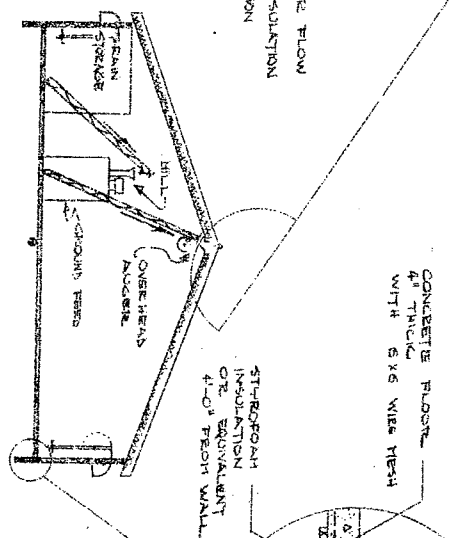

SECTION THROUGH FARROW SIDE

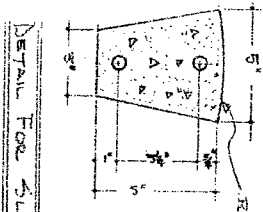

DETAIL FOR SLOTTED FLOOR

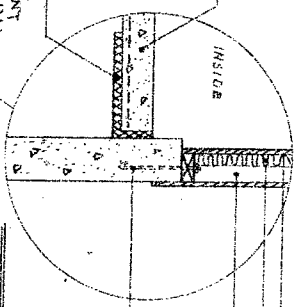

FOUNDATION DETAIL FOR FARROWING SECTION

NOTE

FARROWING SECTION.
SEE SWINE EQUIP. BOOMLET FOR FARROWING PEN DETAILS.
TOTAL FAN CAPACITY - 1200 CFM

INSULATING SECTION
TOTAL FAN CAPACITY - 9400 CFM
2 SMALL FANS, FURNISH CONTINUOUSLY CAPACITY EACH - 1800 CFM.
2 LARGE FANS - THERMOSTATICALLY CONTROLLED CAPACITY EACH - 5500 CFM

INSULATION:
WALLS - 3"
CEILING - 4" TOTAL (AIRSPACE BETWEEN 2-2" INSULATION STRIPS)
VAPOR BARRIER - CONTINUOUSLY ON WALLS & CEILING

MEASURE REINFT. HOLDING CHAMBERS THIS ENO.

ADD 1' TO PEN WIDTH FOR LONGER BUILDING.

CONCRETE FLOOR - 4" THICK WITH 6x6 WIRE MESH

STYROFOAM INSULATION OR EQUIVALENT 4'-0" FEET WALL

VAPOR BARRIER 3" INSULATION 2x4 STUDS - 2" D.C. ANCHOR BOLT FOLLOW FRG. SPECIFICATIONS

ANROWSIDE & FINISHING BARN

DESIGNED BY	LEONARD WALTERBARGER	DATE	
PREPARED BY		REVISED BY	
NO. 230	EXTENSION - AGE. BNGR. DEPT.	DATE	MAY 11, 65
PROJECT NO.	MD 726-1-6	SCALE	1 OF 1