

COOPERATIVE EXTENSION WORK IN
 AGRICULTURE AND HOME ECONOMICS
 STATE OF NORTH DAKOTA
 NORTH DAKOTA STATE UNIVERSITY
 OF AGRICULTURE AND APPLIED SCIENCE AND
 UNITED STATES DEPARTMENT OF AGRICULTURE COOPERATING

Revised Detail of Braces
 for Pole Type Barns
 Revised 9/2/62 sheet 1 of 1

Revised details for Pole Type Barns

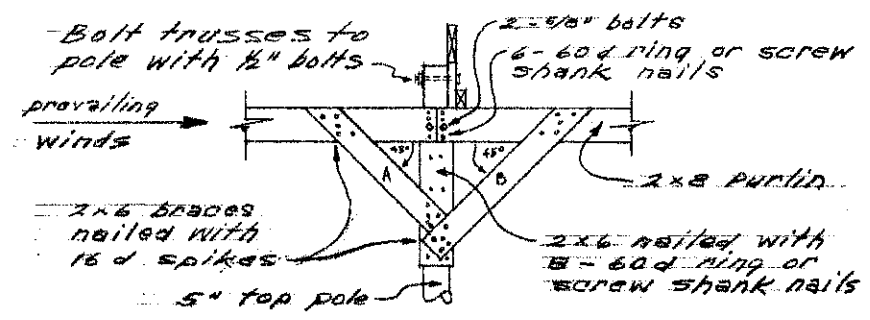

NOTE: short brace "A" should be located towards prevailing winds... west as shown in this drawing.

BACK PURLIN and BRACES

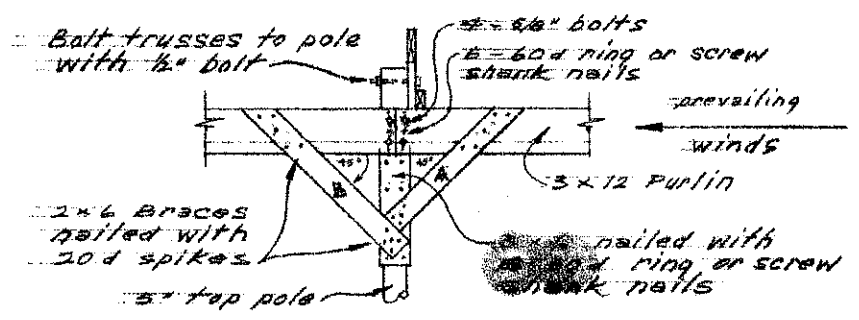

NOTE: short brace "A" should be located towards prevailing winds... shown north in this drawing.

FRONT PURLIN and BRACES

Cooperative Extension Work
 and U.S. Dept. of Agr. cooperating
 Revised 1-5-62 sheet 1 of 1

STATE OF NORTH DAKOTA
 NORTH DAKOTA STATE UNIVERSITY
 OF AGRICULTURE AND APPLIED SCIENCE

BRACINGS FOR POLE TYPE BARNs
 NO. 288-1-62 154.