

TYPICAL SECTION

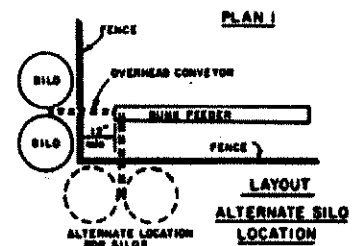

PLAN 1

LAYOUT
ALTERNATE SILO
LOCATION

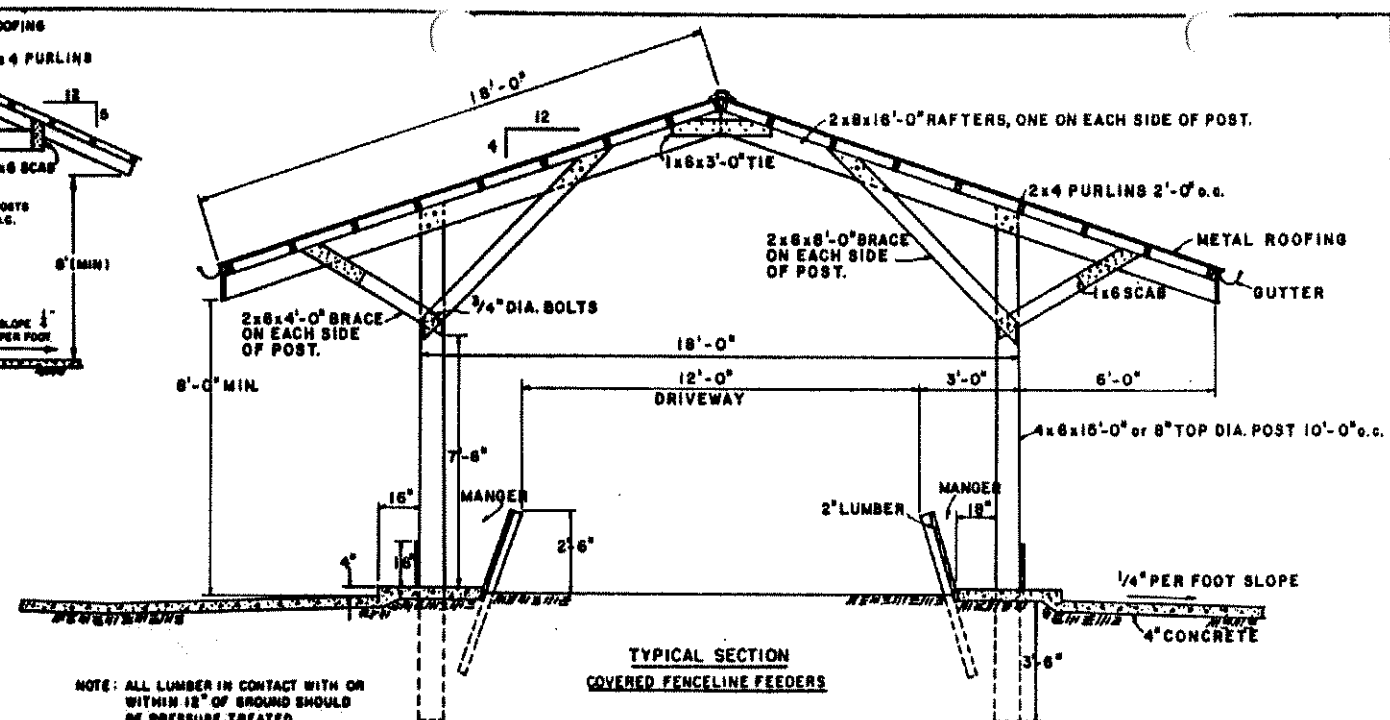

TYPICAL SECTION
COVERED FENCELINE FEEDERS

PLAN 2

NOTE: ALL LUMBER IN CONTACT WITH OR WITHIN 12" OF GROUND SHOULD BE PRESSURE TREATED.
CAUTION: SOME PRESSURE TREATED POSTS & LUMBER USE PRESERVATIVE THAT EPA DOES NOT ALLOW IN CONTACT WITH FEED. IN SUCH CASES, PLYWOOD OR PLASTIC SHOULD BE USED AS A LINER. CHECK SUPPLIER OR LABELS FOR GUIDANCE.

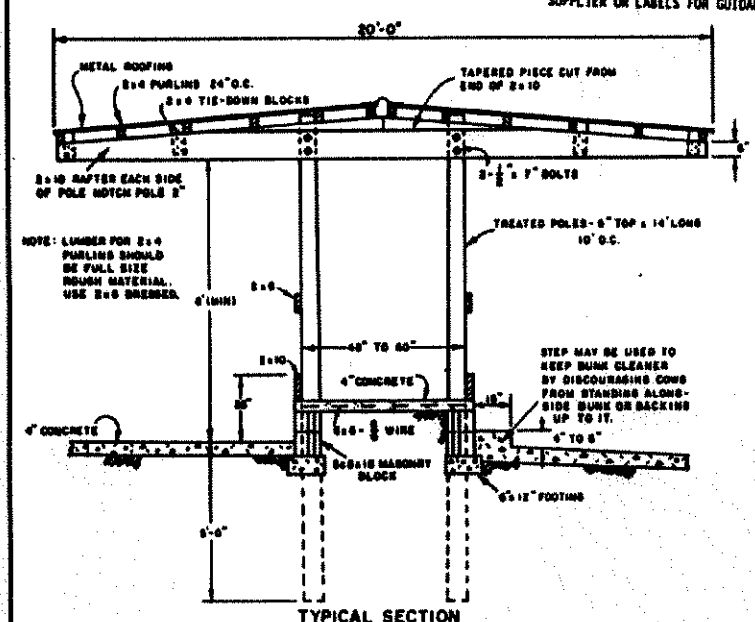

TYPICAL SECTION

PLAN 3

NOTE: LUMBER FOR 2x4 PURLINS SHOULD BE FULL SIZE ROUGH MATERIAL. USE 2x6 DIMENED.

STEP MAY BE USED TO KEEP BUNK CLEANER BY DISCOURAGING COWS FROM STANDING ALONGSIDE BUNK OR BACKING UP TO IT.

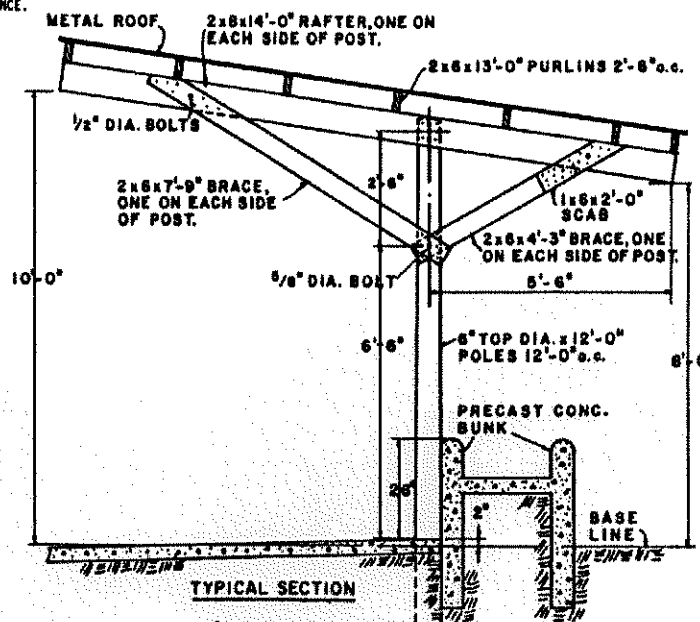

TYPICAL SECTION

PLAN 4

BASED ON: N.C. STATE UNIV. PLAN 2173

COOPERATIVE EXTENSION WORK IN AGRICULTURE AND HOME ECONOMICS

UNITED STATES DEPARTMENT OF AGRICULTURE COOPERATING

SILAGE FEED BUNKS

N.C. '73 EX. 6167 SHEET 1 OF 1

REVISED '88