

ROOF FRAMING PLAN

SCALE: $\frac{3}{16}$ " = 1'-0"

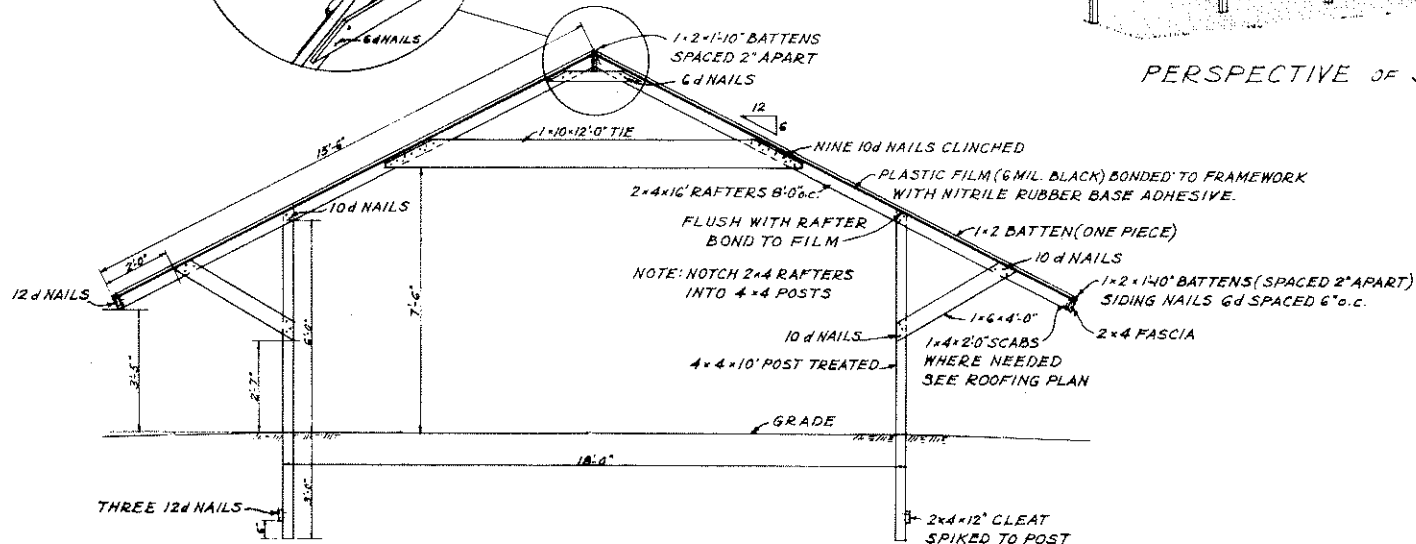
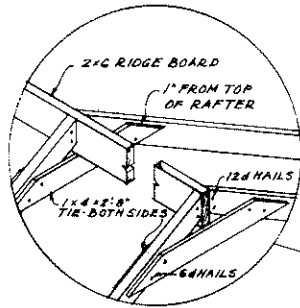

SECTION THRU SHELTER

SCALE: $\frac{3}{8}$ " = 1'-0"

LIST of MATERIALS

POSTS.....	14 PCS.....	4x4x10'
RAFTERS.....	14 PCS.....	2x4x16'
RIDGE BOARD.....	1 PC.....	2x6x14'
	3 PCS.....	2x6x12'
FASCIA.....	2 PCS.....	2x4x14'
	6 PCS.....	2x4x12'
BRACES AND SCABS.....	5 PCS.....	1x6x12'
	1 PC.....	1x6x8'
TIES AND SCABS.....	2 PCS.....	1x4x14'
	2 PCS.....	1x4x12'
TIES.....	7 PCS.....	1x10x12'
CLEATS.....	1 PC.....	2x4x14'
BATTENS.....	23 PCS.....	1x2x16'
PLASTIC FILM-BLACK 6 MIL.....	1 PC.....	32'x50'
NAILS-SIDING.....	6d.....	4 LB.
	10d.....	4 LB.
	COMMON.....	2 LB.
ADHESIVE.....	CAN.....	1 QT.

NOTE: THIS BUILDING IS DESIGNED TO WITHSTAND A LOAD OF 10 LBS. PER SQ. FT. LOCATE SHELTER WHERE TREE BRANCHES CANNOT FALL AND PUNCTURE THE FILM.

ALL LUMBER IN CONTACT WITH THE GROUND SHOULD BE PRESSURE-TREATED WITH A GOOD WOOD PRESERVATIVE. FRAMEWORK AND NAILING STRIPS SHOULD HAVE ROUNDED, SMOOTH EDGES TO AVOID PUNCTURING THE FILM. FILM SHOULD BE APPLIED ON A STILL DAY.

ADHESIVE SHOULD BE APPLIED WHEREVER FILM TOUCHES THE FRAMEWORK. APPLY FILM TAUTLY ON COLD DAYS, APPLY FILM LOOSELY ON WARM DAYS. NON-CORROSIVE FASTENINGS SHOULD BE USED THROUGH-OUT.

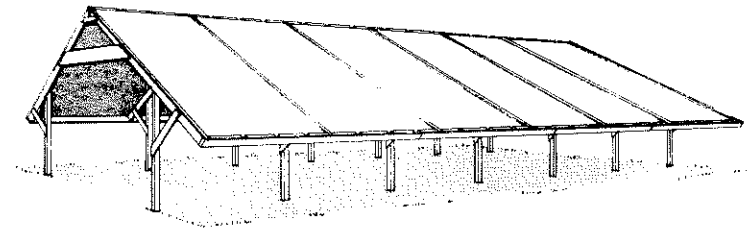

PERSPECTIVE OF SHELTER

COOPERATIVE EXTENSION WORK IN
AGRICULTURE AND HOME ECONOMICS
STATE OF NORTH DAKOTA
NORTH DAKOTA STATE UNIVERSITY
OF AGRICULTURE AND APPLIED SCIENCE
UNITED STATES DEPARTMENT OF AGRICULTURE COOPERATING

SHELTER FOR SHEEP

USDA '61 Ex. 5926 SHEET 1 OF 1

NOTE: BASED ON STUDIES FROM CALIF.