

PERSPECTIVE VIEW

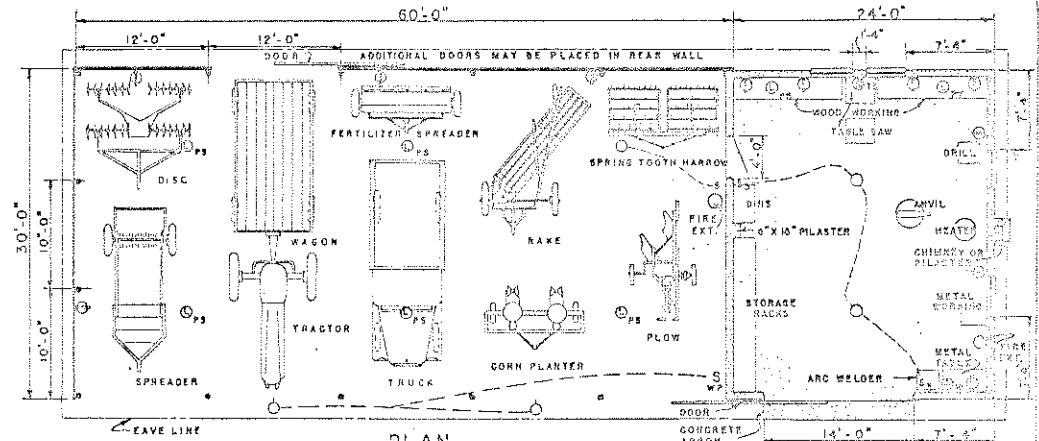

PLAN  
0 4 8 12 FT.

WIRING LEGEND

- LIGHT OUTLET
- ⊕ DUPLEX OUTLET
- ⊕<sub>TS</sub> TABLE SAW OUTLET
- ⊕<sub>W</sub> WELDER OUTLET
- ⊕ LT. WITH PULL SW.
- ⊕ SINGLE POLE SWITCH
- ⊕<sub>3</sub> 3 WAY SWITCH
- ⊕ WEATHERPROOF SW.

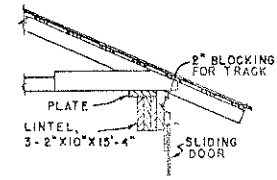

DETAIL AT LINTEL OVER SHOP DOOR

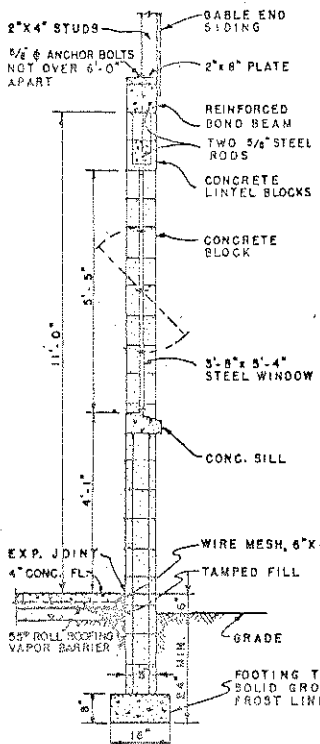
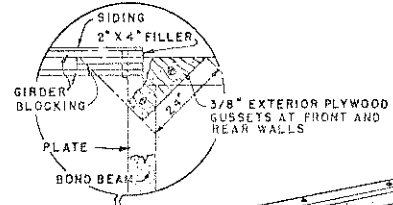

TYPICAL SECTION (END WALL OF SHOP)

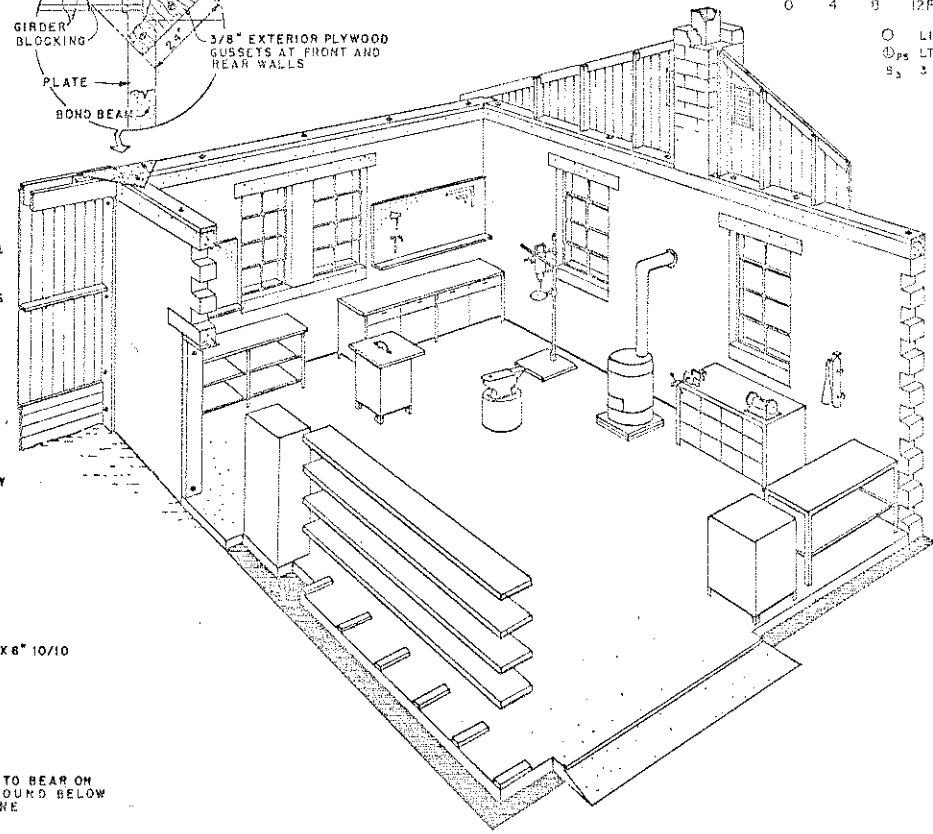

A TYPICAL SHOP ARRANGEMENT

LIST OF MATERIALS

THIS LIST OF MATERIALS IS PREPARED FOR ESTIMATING PURPOSES. IF USED FOR THE PURCHASE OF MATERIALS, THE QUANTITIES SHOULD BE VERIFIED BY THE BUILDER.

ITEM	UNIT	QUAN.
<b>CONCRETE:</b>		
FOOTING 1:3:5 MIX	CU. YD.	3.8
FLOOR, APRON, BOND BEAM ETC. 1:2:4 MIX	CU. YD.	11.1
BLOCK 8" X 8" X 16"	EACH	14.6
8" X 8" X 8"	EACH	8.3
BLOCK LINTEL 8" X 8" X 16"	EACH	2.1
FLUE LINING 8" X 8" X 24"	EACH	2
MORTAR 1:3 MIX	CU. YD.	1.0
EXPANSION JOINT 1/2" X 4"	LN. FT.	10.6
VAPOR BARRIER-ROLL ROOFING 55 LB.	ROLLS	7
REINFORCING STEEL-WIRE MESH 6" X 6" 10/10	SQ. FT.	670
STEEL RODS 3/8" X 16'-0"	EACH	11
5/8" X 14'-0"	EACH	3
ANCHOR BOLTS 3/8" X 2-4"	EACH	27
STEEL BASH 3'-5" X 5'-5" (APPROX.)	EACH	4
METAL LOUVERS	EACH	2

(CONTINUED ON SHEET 2)

THIS BUILDING IS INTENDED PRIMARILY FOR USE IN AREAS NOT SUBJECT TO HIGH WINDS OR SNOW LOADS IN EXCESS OF 10 LBS. PER SQUARE FOOT. IN LOCALITIES WHERE WINDS OF HURRICANE FORCE (OVER 75 m.p.h.) OR SNOW LOADS UP TO 20 LBS. PER SQUARE FOOT MAY BE EXPECTED, USE THE MEMBER SIZES AND FASTENINGS SHOWN IN PARENTHESES (---) AS WELL AS THE OTHER DETAILS FOR HEAVY CONSTRUCTION.

COOPERATIVE EXTENSION WORK IN  
 AGRICULTURE AND HOME ECONOMICS  
 DEPARTMENT OF AGRICULTURAL ENGINEERING  
 UNIVERSITY OF MARYLAND  
 AND  
 UNITED STATES DEPARTMENT OF AGRICULTURE COOPERATING

MACHINERY STORAGE & SHOP

USDA '57 EX. 5849 SHEET 1 OF 1

