

NOTE:
SET ALL POLES IN 18" DIA. HOLES AND TAMP BACKFILL THOROUGHLY. IN LOOSE OR SANDY SOIL, A CONCRETE FILL MAY BE REQUIRED.

CROSS SECTION

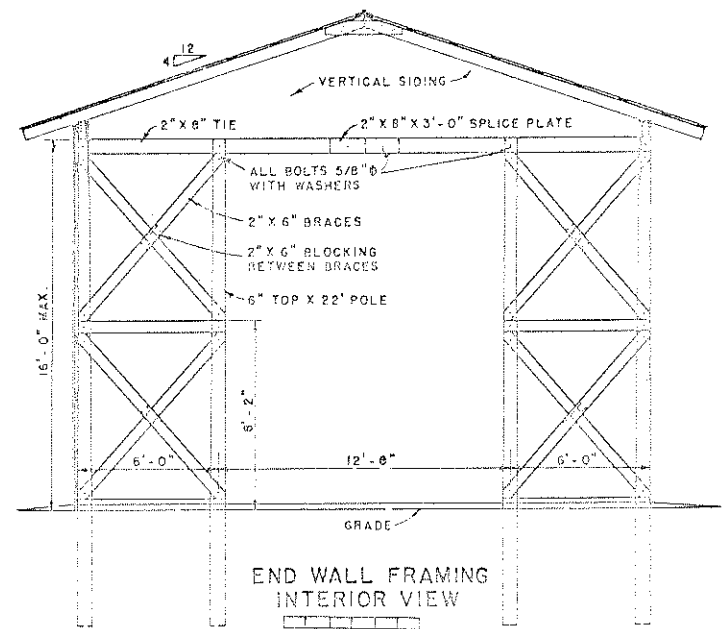

END WALL FRAMING INTERIOR VIEW

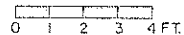
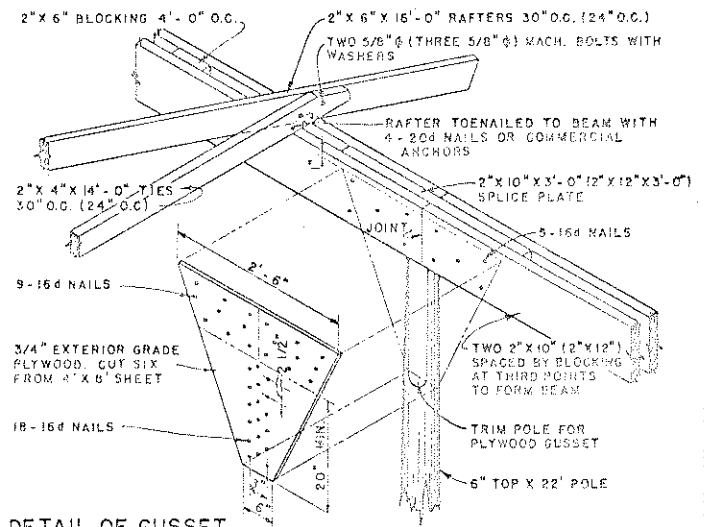

DETAIL OF GUSSET CONNECTION AT POLE

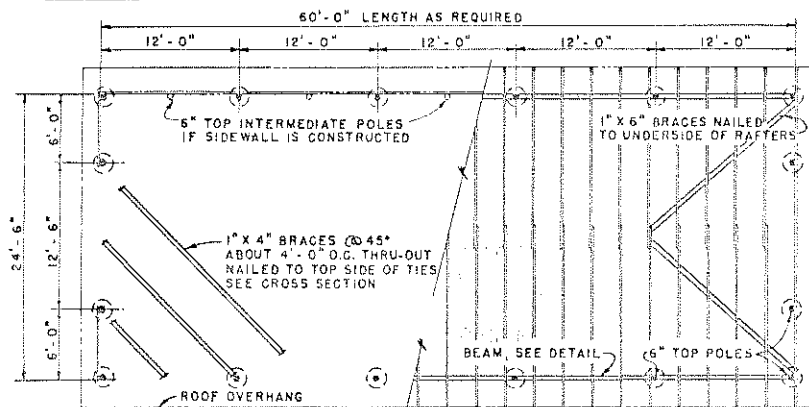

FLOOR AND ROOF FRAMING PLAN

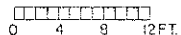

NOTE:
ALL POLES AND SPLASH BOARDS TO BE PRESSURE TREATED WITH PRESERVATIVE. THIS BUILDING MAY BE BUILT IN ANY LENGTH DESIRED IN UNITS OF 12'-0". IT IS DESIGNED FOR AREAS OF THE UNITED STATES WHERE THE SNOW LOAD IS 20 LB. (OR 30 LB.) PER SQUARE FOOT OR WIND DOES NOT EXCEED 88 MILES PER HOUR. FRAMING SIZE AND NAILS FOR 30 LB. LOAD SHOWN IN PARENTHESES (...).

COOPERATIVE EXTENSION WORK IN
AGRICULTURE AND HOME ECONOMICS
DEPARTMENT OF AGRICULTURAL ENGINEERING
UNIVERSITY OF MARYLAND
UNITED STATES DEPARTMENT OF AGRICULTURE COOPERATING

HAY SHED
24' WIDE-POLE CONSTRUCTION

USDA '57 L 5847 SHEET 1 OF 1