

NOTE A:
1" x 6" DIAGONAL BRACES ALONG EACH SIDE WALL AND UNDER ROOF RAFTERS ON ALL TYPES OF ROOF STRUCTION

NOTE B:
EXTEND THE 1" x 6" BRACES TO SUPPORT EUMSHADE IF NEEDED.

THESE BUILDINGS ARE INTENDED FOR USE IN WARM AREAS NOT SUBJECT TO HIGH WINDS OR SNOW LOADS IN EXCESS OF 10 LBS. PER SQ. FT.

COOPERATIVE EXTENSION WORK IN AGRICULTURE AND HOME ECONOMICS		
AGRICULTURAL EXTENSION SERVICE		
UNIVERSITY OF ARIZONA		
AND UNITED STATES DEPARTMENT OF AGRICULTURE COOPERATING		
CALIFORNIA TYPE		
CAGE LAYING HOUSES		
CAL. '87	EX 5845	SHEET 1 OF 2

POULTRY

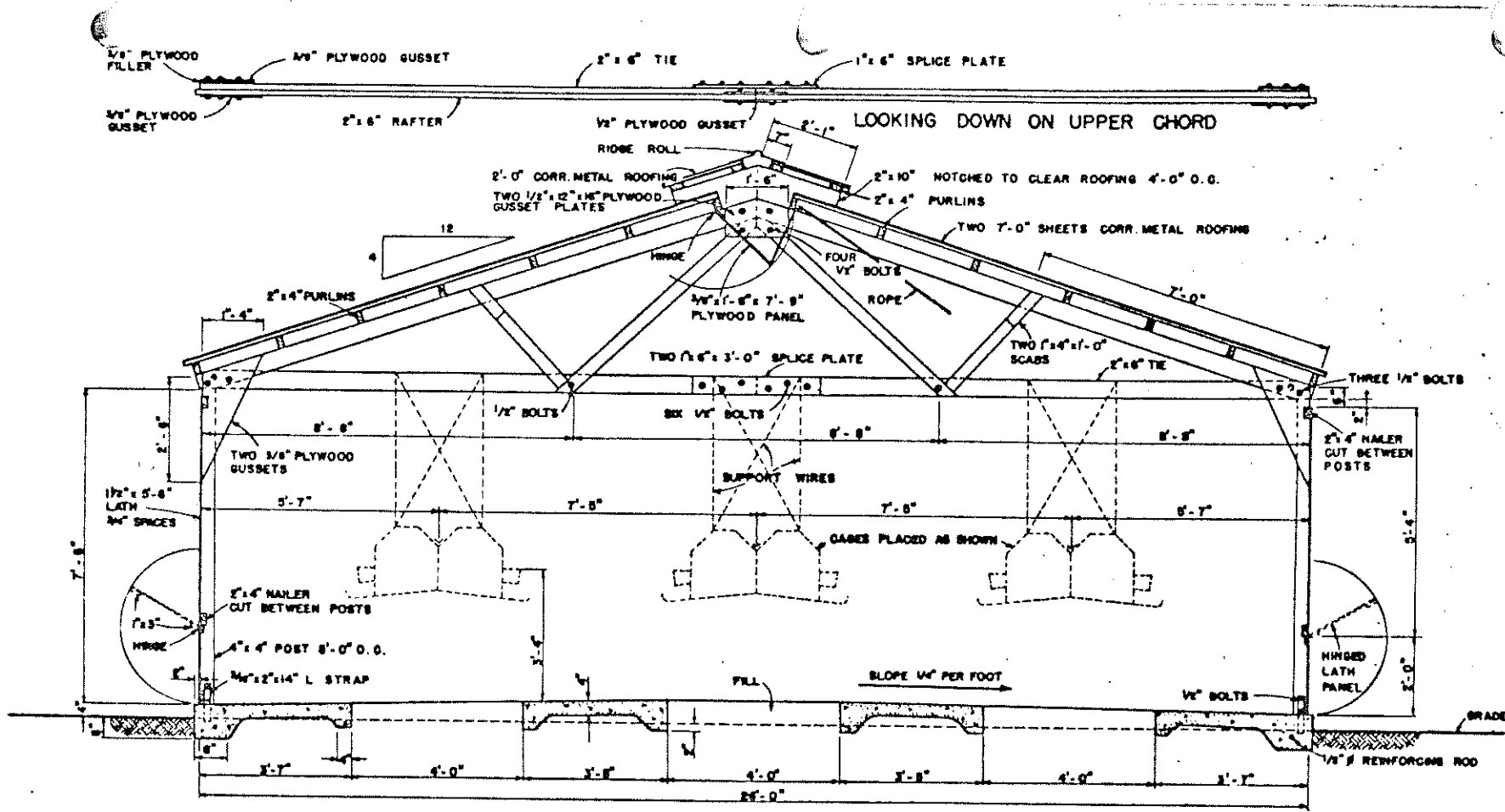

SIX ROW HOUSE

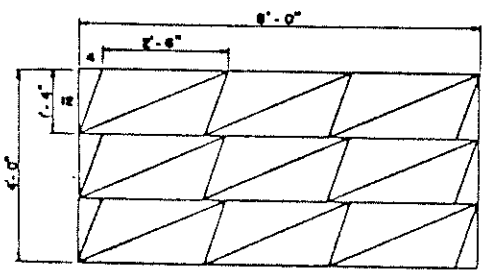

PLYWOOD CUTTING SCHEDULE
EXTERIOR GRADE PLYWOOD

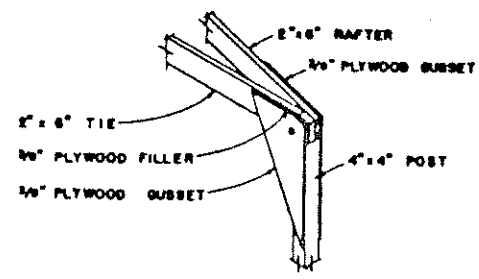
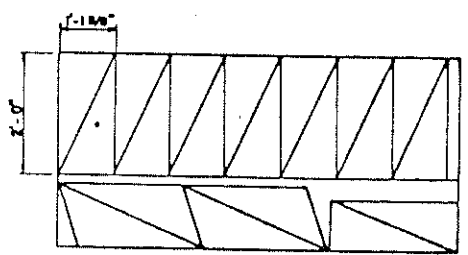

CORNER JOINT DETAIL

COOPERATIVE EXTENSION WORK IN
AGRICULTURE AND HOME ECONOMICS
AGRICULTURAL EXTENSION SERVICE
UNIVERSITY OF ARIZONA
AND
UNITED STATES DEPARTMENT OF AGRICULTURE COOPERATING

CALIFORNIA TYPE
CAGE LAYING HOUSES

GAL.	'57	EX. 5845	SHEET 2 OF 2
------	-----	----------	--------------

Poultry