

FRONT ELEVATION

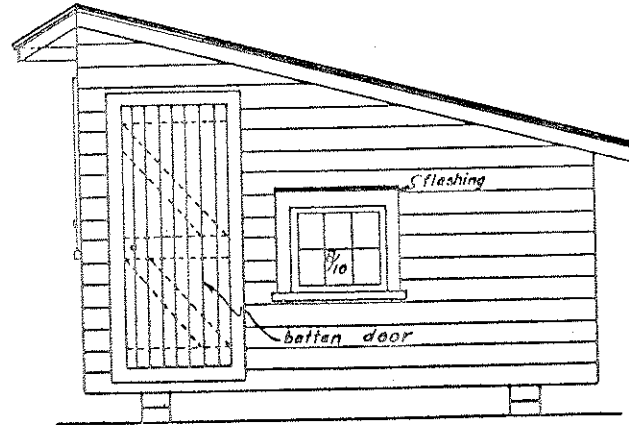

END ELEVATION

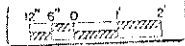
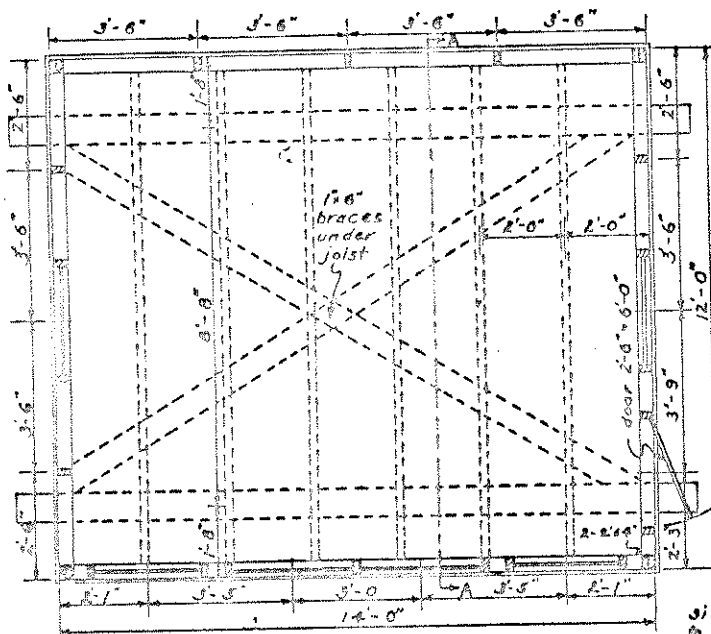
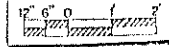

PLAN

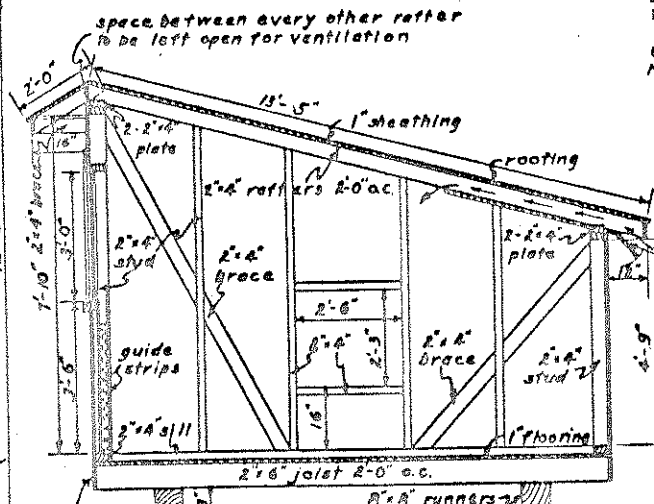
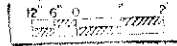

CROSS SECTION-AA

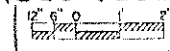

BILL OF MATERIALS

USE	No. PCS	SIZE	LENGTH
Runners:	2	8" x 8"	10'-0"
Joist:	8	2" x 6"	12'-0"
Sills	2	2" x 4"	12'-0"
	2	2" x 4"	12'-0"
Studs	18	2" x 4"	8'-0"
"	1	2" x 4"	12'-0"
"	4	2" x 4"	10'-0"
Rafters	8	2" x 4"	14'-0"
"	2	2" x 4"	8'-0"
Plates	4	2" x 4"	14'-0"
Headers	2	2" x 4"	10'-0"
"	1	2" x 4"	12'-0"
BRACES:	3	2" x 4"	16'-0"
"	2	2" x 4"	10'-0"
"	2	1" x 6"	16'-0"
Trim	4	1" x 4"	12'-0"
"	2	1" x 4"	8'-0"

Glass cloth frame 2 pcs 1 1/4" x 12'-0"  
 Sheathing 280 sq. ft.  
 Roofing 2.5 sqs.  
 Flooring (T & G) 200 sq. ft.  
 Ceiling (T & G) 90 sq. ft.  
 Door 1- 2'-6" x 6'-0" batten  
 Windows 2- Single Sash 6 1/2 x 8 1/2"  
 " 2- Double Sash 12 1/2 x 8 1/2"  
 Glass cloth - 12 sq. ft.  
 Nails, paint, & other hardware

CAPACITY: 400 CHICKS

COOPERATIVE EXTENSION WORK IN  
 AGRICULTURE AND HOME ECONOMICS  
 AND  
 U.S. DEPT. OF AGRICULTURE COOPERATING.