

• PLAN VIEW •
SCALE 1/2" = 6'-0"

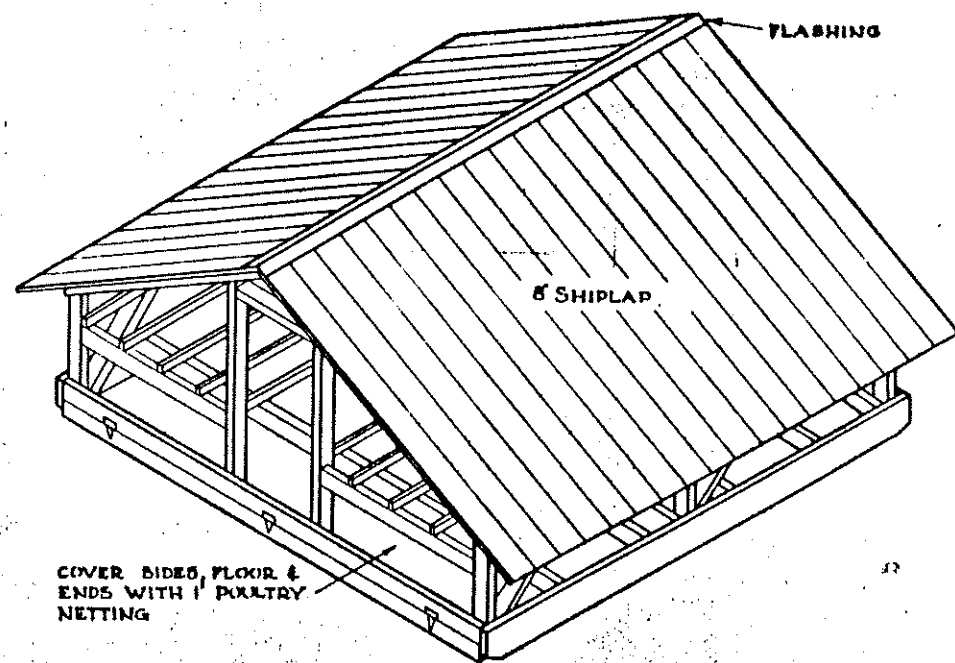

COVER SIDES, FLOOR & ENDS WITH 1" POULTRY NETTING

• ISOMETRIC VIEWS •
SCALE 1/2" = 6'-0"

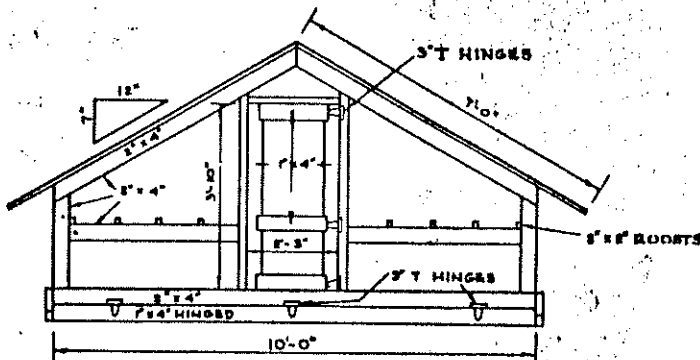

• FRONT ELEVATION •
SCALE 1/2" = 6'-0"

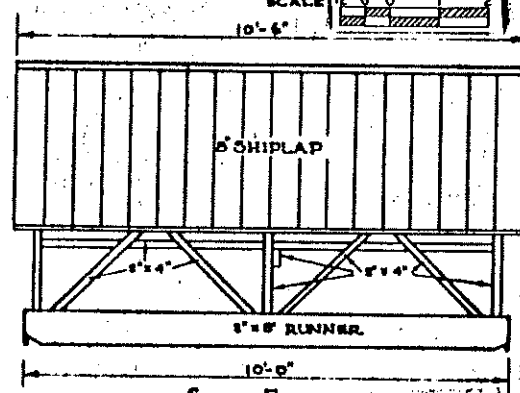

• SIDE ELEVATION •
SCALE 1/2" = 6'-0"

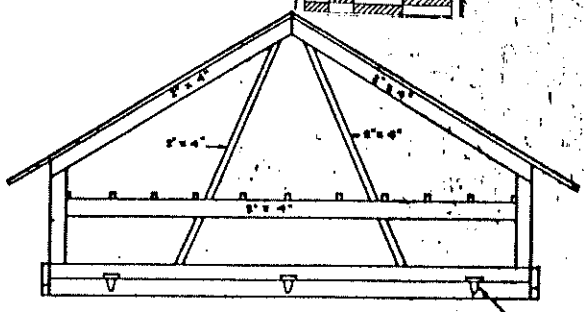

• REAR VIEW •
SCALE 1/2" = 6'-0"

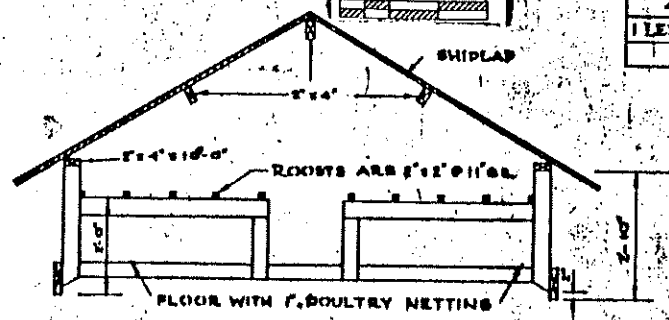

• SECTION •
SCALE 1/2" = 6'-0"

• BILL OF MATERIAL •

NUMBER	SIZE	LENGTH	REMARKS
2	2" x 6"	10'-0"	RUNNERS
10	2" x 2"	10'-0"	ROOTS
3	1" x 4"	10'-0"	
12	2" x 4"	10'-0"	
6	2" x 4"	6'-0"	
6	2" x 4"	7'-0"	
18	6"	14'-0"	SHIPLAP
9	3"		T HINGES
6 LBS	8d		WIRE NAIL
1	10 LBS	16d	
4 LBS			SMALL STAPLES
1 LENGTH	24" WIRE	110'-0"	1" POULTRY NETTING
1	6" WIDE	10'-6"	G.I. FLASHING

COOPERATIVE EXTENSION WORK IN
AGRICULTURE AND HOME ECONOMICS
AND
U. S. DEPT. OF AGRICULTURE COOPERATING
SUMMER RANGE POULTRY SHELTER
MW. EX. 5400 SHEET 1 OF 1